

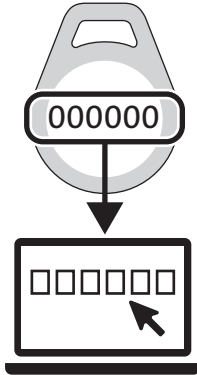

- GB** LD5400T Multi-User Thunderbolt 3 Dock with K-Fob™ Smart Lock
- DE** LD5400T Thunderbolt 3-Dock für mehrere Benutzer mit intelligentem K-Fob™-Schloss
- FR** Station d'accueil LD5400T Thunderbolt 3 multi-utilisateurs avec clé K-Fob™
- NL** LD5400T Thunderbolt 3 dock met K-Fob™ Smart Lock voor meerdere gebruikers
- ES** Replicador Thunderbolt 3 para múltiples usuarios LD5400T con candado K-Fob™ Smart
- IT** Docking station LD5400T Thunderbolt 3 per più utenti con lucchetto smart K-Fob™
- PT** Conector LD5400T Thunderbolt 3 com K-Fob™ para multiutilizador
- DK** LD5400T Thunderbolt™ 3 dock med K-Fob™ og Smartlås for flere brugere
- NO** LD5400T Thunderbolt™ 3-dokkingstasjon med K-Fob™-smartlås for flere brukere
- SE** LD5400T Thunderbolt™ 3-docka för flera användare med K-Fob™ smart lås
- FI** LD5400T monikäyttävä Thunderbolt™ 3 -telakka, jossa K-Fob™ Smart Lock
- EE** LD5400T mitme kasutaja Thunderbolt 3 dokk koos nutika lukuga K-Fob™
- LV** LD5400T Thunderbolt 3 dokstacija vairākiem lietotājiem ar K-Fob™ viedo slēdzeni
- LT** LD5400T Kelių naudotojų „Thunderbolt 3“ dokas su „K-Fob™“ išmaniuoju užraktu
- PL** Stacja dokująca LD5400T dla wielu użytkowników z interfejsem Thunderbolt 3 i kluczem K-Fob™ Smart Lock
- CZ** Dokovací stanice LD5400T Thunderbolt 3 s chytrým zámkem K-Fob™ pro více uživatelů
- SK** Dokovacia stanica pre viacerých používateľov LD5400T Thunderbolt 3 so zámkom K-Fob™ Smart Lock
- HU** LD5400T többfelhasználós Thunderbolt 3 dokkoló K-Fob™ okoszárral
- RO** Stație de andocare LD5400T Thunderbolt 3 pentru mai mulți utilizatori cu K-Fob™ Smart Lock
- RU** Станция для нескольких пользователей LD5400T Thunderbolt 3 с замком и ключом K-Fob™
- UA** Док-станція LD5400T Multi-User Thunderbolt 3 з технологією K-Fob™ Smart Lock
- KZ** LD5400T көп пайдаланушыға арналған Thunderbolt 3 Dock, K-Fob™ Smart Lock бап
- TR** K-Fob™ Akıllı Kilitli LD5400T Çok Kullanıcıli Thunderbolt 3 Takma Yeri
- GR** Βάση LD5400T Thunderbolt 3 πολλαπλών χρηστών με έξυπνο κλειδωμα K-Fob™
- CN** LD5400T 多路 Thunderbolt 3 扩展坞 (带 K-Fob™ 智能防盗锁)
- JP** K-Fob™ スマート ロック付き LD5400T マルチ ユーザー Thunderbolt 3 ドック
- AE** قاعدة شحن LD5400T Thunderbolt 3 لعدة مستخدمين مزودة بتقنية القفل الذكي K-Fob™ Smart Lock



[kensington.com/register](https://kensington.com/register)



[kensington.com/register](https://kensington.com/register)



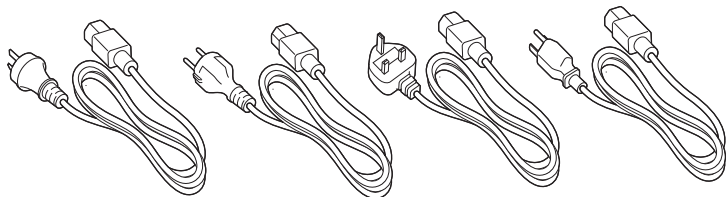
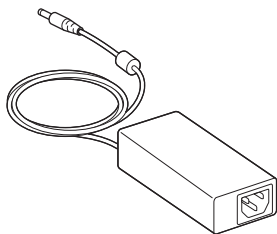
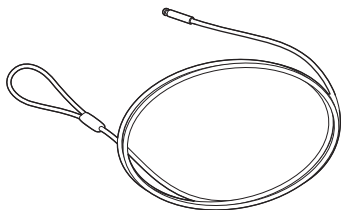
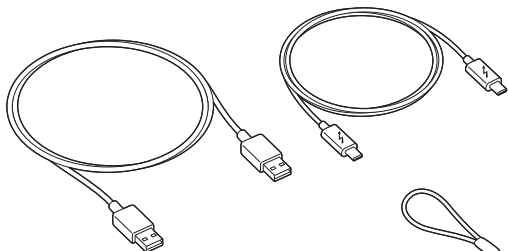
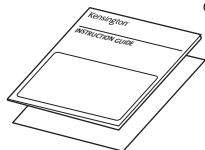
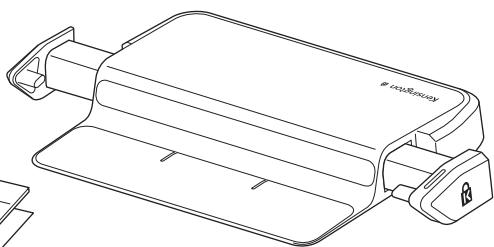

#

--	--	--	--	--	--

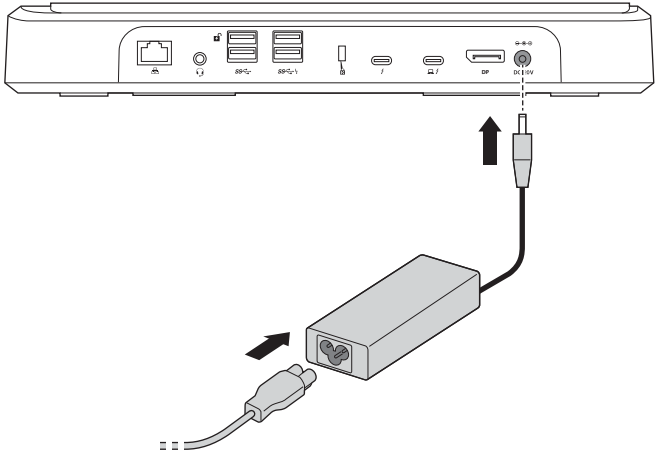

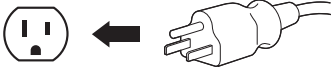
1



<b>NA</b>	 <p>Diagram showing a North American (NA) power plug and its corresponding outlet. The outlet has two vertical slots and a ground pin. The plug has two flat blades and a ground pin.</p>
<b>AU / 中国</b>	 <p>Diagram showing an Australian (AU) or Chinese power plug and its corresponding outlet. The outlet has three slots: two slanted and one vertical. The plug has three pins: two slanted and one vertical.</p>
<b>UK</b>	 <p>Diagram showing a United Kingdom (UK) power plug and its corresponding outlet. The outlet has three slots: two horizontal and one vertical. The plug has three pins: two horizontal and one vertical.</p>
<b>EU</b>	 <p>Diagram showing a European Union (EU) power plug and its corresponding outlet. The outlet has two circular holes. The plug has two round pins.</p>

2

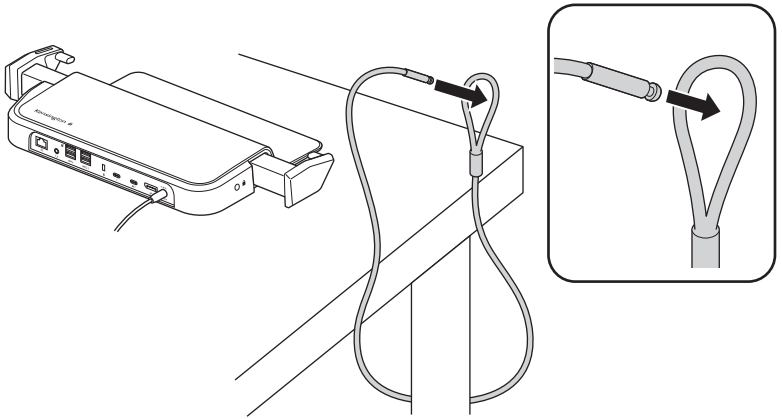

3

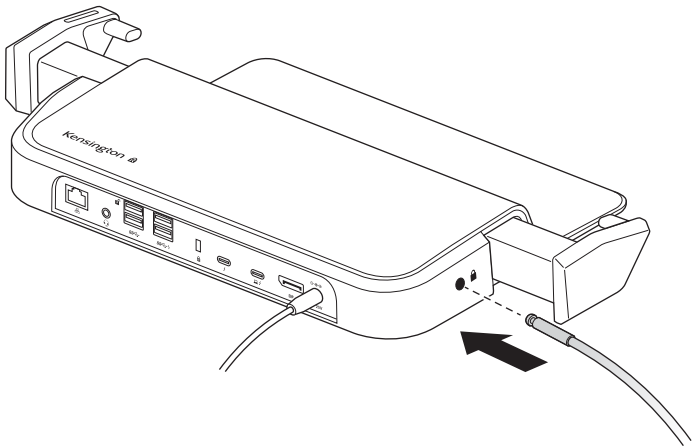

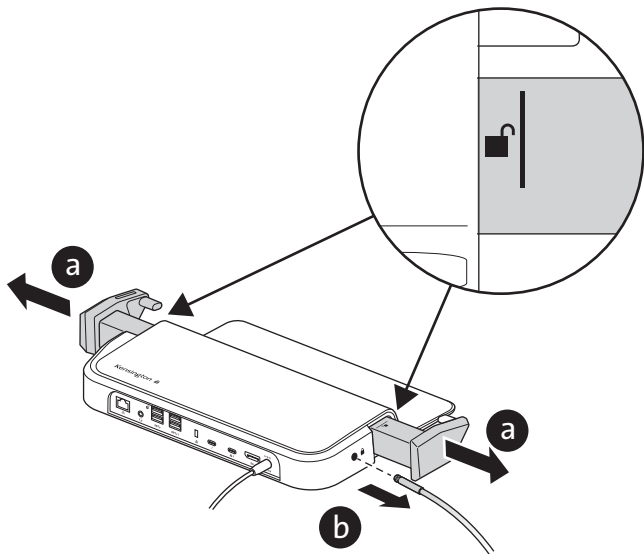
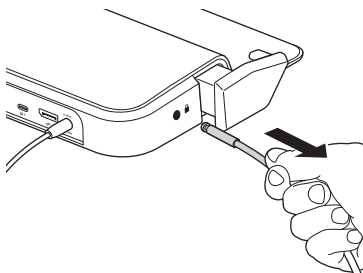
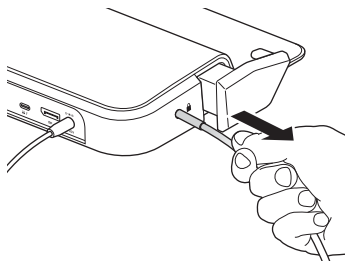



1

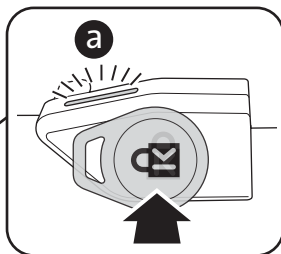
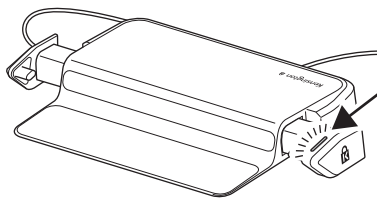

2

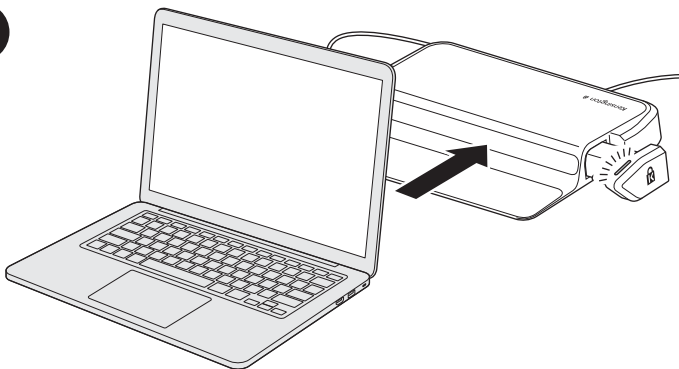

3



1

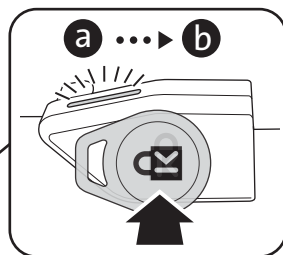
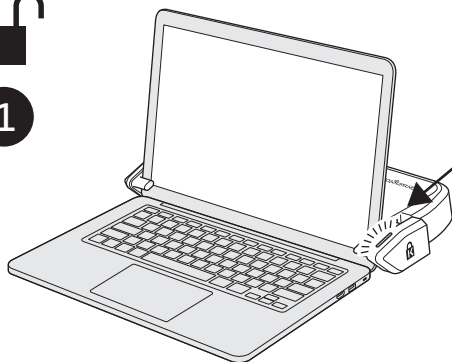

2



3

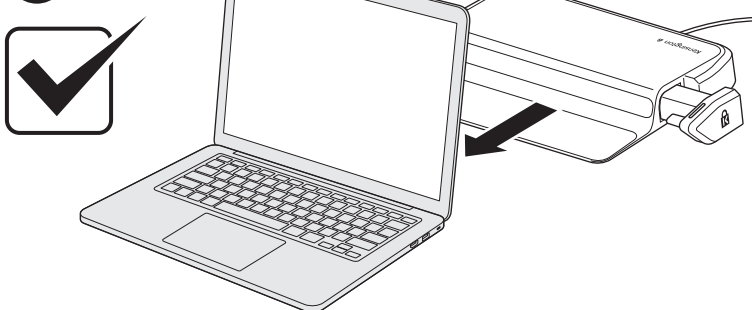



**GB**

LED Color	Status
Ⓐ Green	Lock
Ⓑ Blue	Unlock
Red (Flashes 4x)	Error (wrong fob)

**DE**

LED-Farbe	Status
Ⓐ Grün	Schließen
Ⓑ Blau	Öffnen
Rot (blinkt 4 x)	Fehler (falscher K-Fob)

**FR**

Couleur du voyant	État
Ⓐ Vert	Verrouillage
Ⓑ Bleu	Déverrouillage
Rouge (clignote 4 fois)	Erreur (clé incorrecte)

**NL**

Led-kleur	Status
Ⓐ Groen	Vergrendelen
Ⓑ Blauw	Ontgrendelen
Rood (knippert vier keer)	Fout (incorrecte Fob)

**ES**

Color LED	Estado
Ⓐ Verde	Bloqueado
Ⓑ Azul	Desbloqueado
Rojo (4x intermitentes)	Error (llave incorrecta)

**IT**

Colori LED	Status
Ⓐ Verde	Blocca
Ⓑ Blu	Sblocca
Rosso (lampeggia 4 volte)	Errore (portachiavi errato)

**PT**

Cor do LED	Estado
Ⓐ Verde	Bloqueado
Ⓑ Azul	Desbloqueado
Vermelho (pisca 4x)	Erro (chave incorreta)

**DK**

LED-farve	Status
Ⓐ Grøn	Lås
Ⓑ Blå	Lås op
Rød (Blinker 4X)	Fejl (Forkert Fob)

**NO**

LED-farge	Status
Ⓐ Grønn	Låse
Ⓑ Blå	Låse opp
Rød (blinker fire ganger)	Feil (feil fob)

**SE**

LED-färg	Status
Ⓐ Grön	Låsa
Ⓑ Blå	Låsa upp
Röd (blinker 4 gånger)	Fel (fel Fob)

**FI**

LED-väri	Tila
Ⓐ Vihreä	Lukitse
Ⓑ Sininen	Poista lukitus
Punainen (välihtää 4x)	Virhe (väärällinen Fob)

**EE**

Leedi värv	Olek
Ⓐ Roheline	Lukustus
Ⓑ Sinine	Lukust vastustus
Punane (vilgub 4 korda)	Tõrge (vale ripats)

**LV**

LED krāsa	Statuss
Ⓐ Zāla	Blokēt
Ⓑ Zīla	Atblokēt
Sarkana (mirgo 4 reizes)	Kļūda (nepareiza atslēga)

**LT**

LED spalva	Būsena
Ⓐ Žalia	Užrakinti
Ⓑ Mėlyna	Atrakinti
Raudona (mirksi 4 k.)	Klaida (netinkamas pakabukas)

**PL**

Kolor LED	Status
Ⓐ Zielony	Blokada
Ⓑ Niebieski	Odblokowanie
Czerwony (miga 4x)	Błąd (nieprawidłowy klucz)

**CZ**

Barva kontrolky LED	Status
Ⓐ Zelená	Zamknout
Ⓑ Modrá	Odemknout
Červená (4x zabliká)	Chyba (nesprávný zámek K-Fob)

**SK**

Farby LED	Stav
Ⓐ zelená	zamknúť
Ⓑ modrá	odomknúť
červená (blesk 4X)	Chyba (neprávny zámok)

**HU**

LED színe	Állapot
Ⓐ Zöld	Zár
Ⓑ Kék	Felold
Piros (4-szer villan fel)	Hiba (rossz FOB)

**RO**

Culoare LED	Stare
Ⓐ Verde	Blocare
Ⓑ Albastru	Deblocare
Rosu (Se aprinde intermitent 4X)	Eroare (Element fob greșit)

**RU**

Цвет индикатора	Состояние
Ⓐ Зеленый	Заблокировано
Ⓑ Синий	Разблокировано
Красный (мигает 4 раза)	Ошибка (неправильный Fob)

**UA**

Колір світлодіодного індикатора	Статус
Ⓐ Зелений	Заблоковано
Ⓑ Синій	Розблоковано
Червоний (блимає 4 рази)	Помилка (неправильний брелок-контролер)

**KZ**

Жарықдиод түсі	Статус
Ⓐ Жасыл	Құлыптау
Ⓑ Көк	Құлыпты ашу
Қызыл (4 рет жыпылықтайды)	Қате (жарамсыз кілт)

**TR**

LED Rengi	Durum
Ⓐ Yeşil	Kilitli
Ⓑ Mavi	Kilitli Değil
Kırmızı (4 Kez Yanıp Sönür)	Hata (Yanlış Anahtarlık)

**GR**

Χρώμα LED	Κατάσταση
Ⓐ Πράσινο	Κλειδωμένο
Ⓑ Μπλε	Ξεκλειδωμένο
Κόκκινο (Αναβοσβήνει 4X)	Σφάλμα (Λανθασμένο fob)

**CN**

LED 指示灯颜色	状态
Ⓐ 绿色	锁定
Ⓑ 蓝色	解锁
红色 (闪烁 4 次)	错误 (错误密钥终端)

**JA**

LED の色	ステータス
Ⓐ 緑	ロック
Ⓑ 青	ロック解除
赤 (4 回点滅)	エラー (誤った FOB)

**AE**

الحالة	LED لون
قفل	Ⓐ أخضر
فتح القفل	Ⓑ أزرق
خطأ (مفتاح أمان غير صحيح)	Ⓒ أحمر (يوميض 4 مرات)

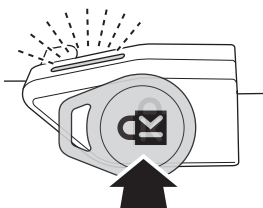

<b>GB</b>	Red (Flashes 4X)	Error (wrong fob)	<b>PL</b>	Czerwony (miga 4x)	Błąd (nieprawidłowy klucz)
<b>DE</b>	Rot (blinkt 4 x)	Fehler (falscher K-Fob)	<b>CZ</b>	Červená (4x zabliká)	Chyba (nesprávný zámek K-Fob)
<b>FR</b>	Rouge (clignote 4 fois)	Erreur (clé incorrecte)	<b>SK</b>	červená (blesk 4X)	Chyba (neprávny zámok)
<b>NL</b>	Rood (knippert vier keer)	Fout (incorrecte Fob)	<b>HU</b>	Piros (4-szer villan fel)	Hiba (rossz FOB)
<b>ES</b>	Rojo (4x intermitentes)	Error (llave incorrecta)	<b>RO</b>	Roșu (Se aprinde intermitent 4X)	Eroare (Element fob greșit)
<b>IT</b>	Rosso (lampeggia 4 volte)	Errore (portachiavi errato)	<b>RU</b>	Красный (мигает 4 раза)	Ошибка (неправильный Fob)
<b>PT</b>	Vermelho (pisca 4x)	Erro (chave incorreta)	<b>UA</b>	Червоний (блимає 4 рази)	Помилка (неправильний брелок-контролер)
<b>DK</b>	Rød (Blinker 4X)	Fejl (Forkert Fob)	<b>KZ</b>	Қызыл (4 рет жыпылықтайды)	Қате (жарамсыз кілт)
<b>NO</b>	Rød (blinker fire ganger)	Feil (feil fob)	<b>TR</b>	Kırmızı (4 Kez Yanıp Söner)	Hata (Yanlış Anahtarlık)
<b>SE</b>	Röd (blinker 4 gånger)	Fel (fel Fob)	<b>GR</b>	Κόκκινο (Αναβοσβήνει 4X)	Σφάλμα (Λανθασμένο fob)
<b>FI</b>	Punainen (välähtää 4x)	Virhe (väärällinen Fob)	<b>CN</b>	红色 (闪烁 4 次)	错误 (错误密钥终端)
<b>EE</b>	Punane (vilgub 4 korda)	Tõrge (vale ripats)	<b>JA</b>	赤 (4 回点滅)	エラー (誤ったフォブ)
<b>LV</b>	Sarkana (mirgo 4 reizes)	Kļūda (nepareiza atslēga)	<b>AE</b>	أحمر (يومض 4 مرات)	خطأ (مفتاح أمان غير صحيح)
<b>LT</b>	Raudona (mirksi 4 k.)	Klaida (netinkamas pakabukas)			

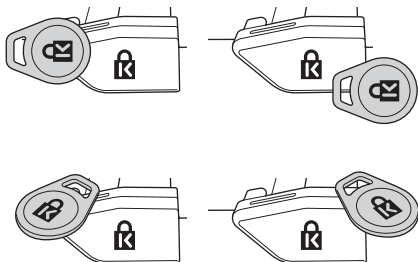
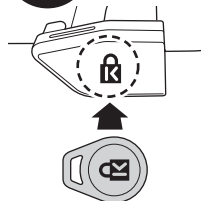

# #8 / M4

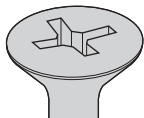

<b>GB</b>	* Sold separately	<b>PL</b>	* Sprzedawane oddzielnie
<b>DE</b>	* Separat erhältlich	<b>CZ</b>	* Prodává se samostatně
<b>FR</b>	* Vendu séparément	<b>SK</b>	* Predáva sa samostatne
<b>NL</b>	* Sold Separately	<b>HU</b>	* Külön vásárolható meg
<b>ES</b>	* Se vende por separado	<b>RO</b>	* Comercializat separat
<b>IT</b>	* Venduto separatamente	<b>RU</b>	* Продаётся отдельно
<b>PT</b>	* Vendido em separado	<b>UA</b>	* Продається окремо
<b>DK</b>	* Skal købes separat	<b>KZ</b>	* Бөлек сатылады
<b>NO</b>	* Selges separat	<b>TR</b>	* Ayrıca Satılır
<b>SE</b>	* Säljs separat	<b>GR</b>	* Πωλείται ξεχωριστά
<b>FI</b>	* Myydään erikseen	<b>CN</b>	* 单独出售
<b>EE</b>	* Müüakse eraldi	<b>JP</b>	* 別売
<b>LV</b>	* Iegādājams atsevišķi	<b>AE</b>	* يُباع بشكل منفصل *
<b>LT</b>	* Įsigijama atskirai		

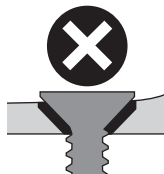
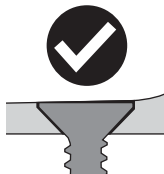
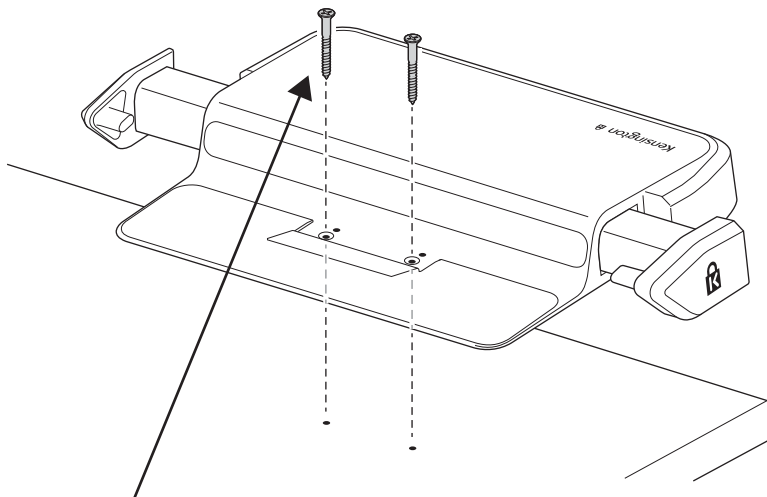

4

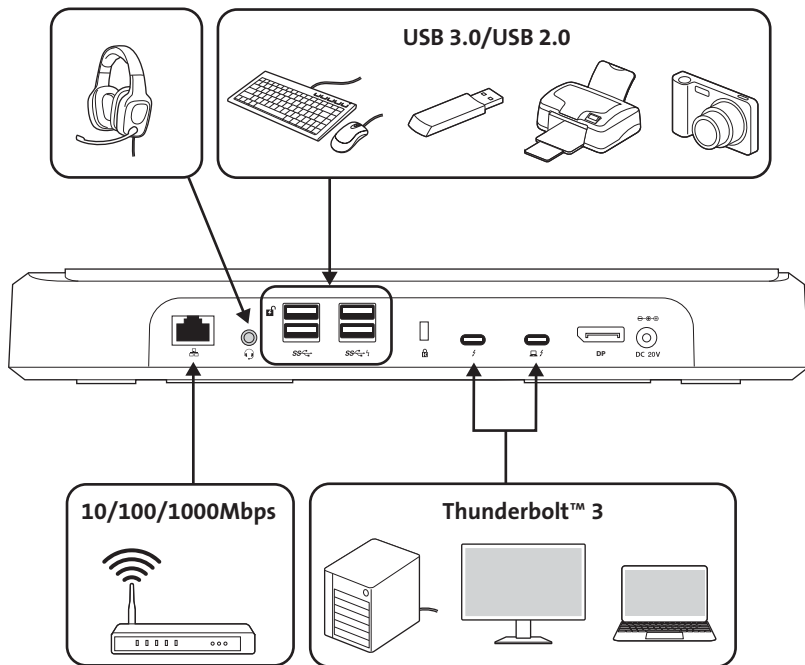
**GB** \* Sold separately**DE** \* Separat erhältlich**FR** \* Vendu séparément**NL** \* Sold Separately**ES** \* Se vende por separado**IT** \* Venduto separatamente**PT** \* Vendido em separado**DK** \* Skal købes separat**NO** \* Selges separat**SE** \* Säljs separat**FI** \* Myydään erikseen**EE** \* Müüakse eraldi**LV** \* Iegādājams atsevišķi**LT** \* Įsigijama atskirai**PL** \* Sprzedawane oddzielnie**CZ** \* Prodává se samostatně**SK** \* Predáva sa samostatne**HU** \* Külön vásárolható meg**RO** \* Comercializat separat**RU** \* Продается отдельно**UA** \* Продається окремо**KZ** \* Бөлек сатылады**TR** \* Ayrıca Satılır**GR** \* Πωλείται ξεχωριστά**CN** \* 单独出售**JP** \* 別売**AE** \* يُباع بشكل منفصل\*

5

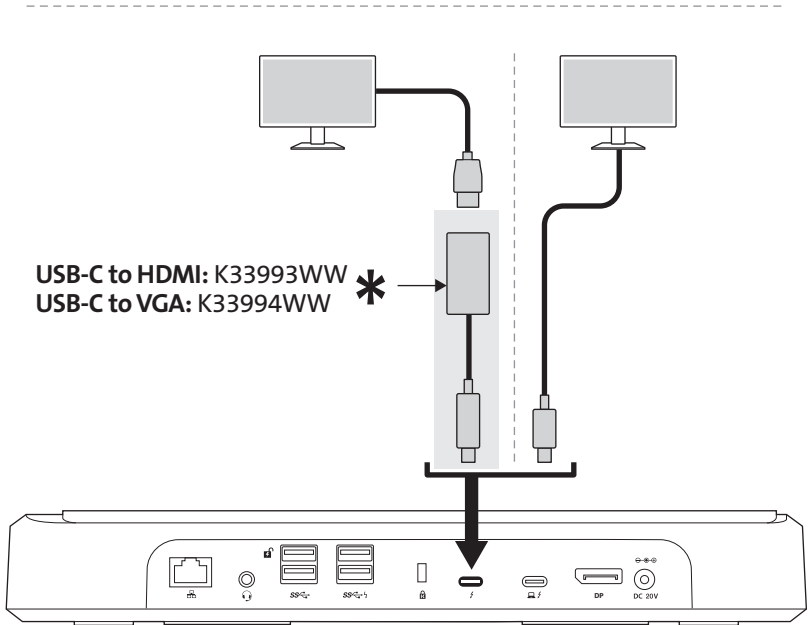
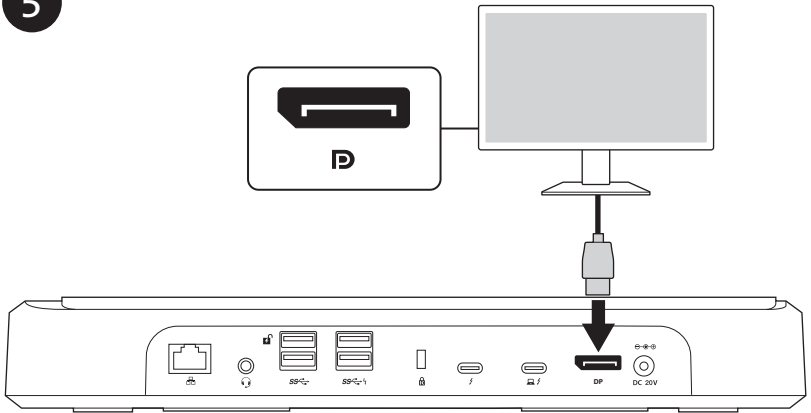

6

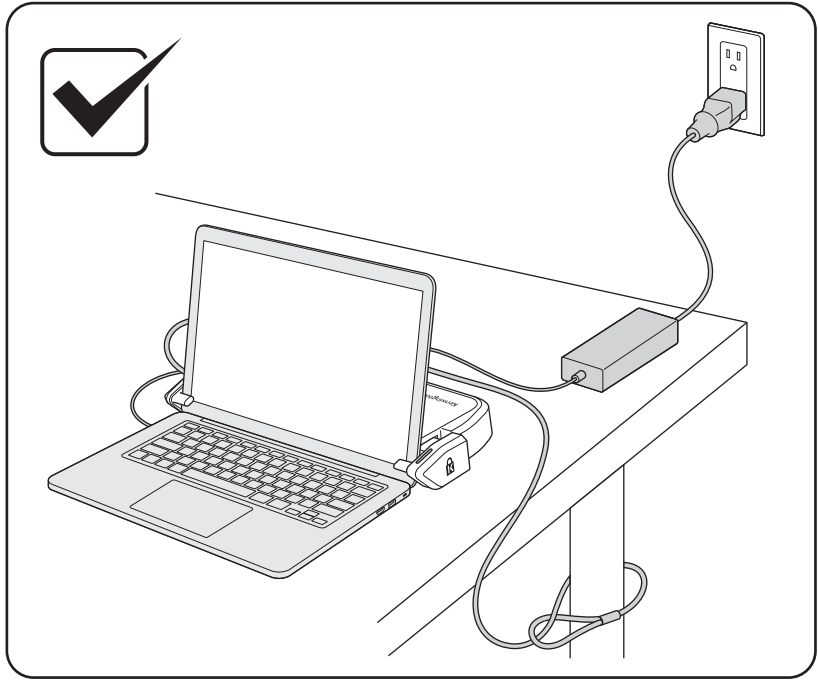
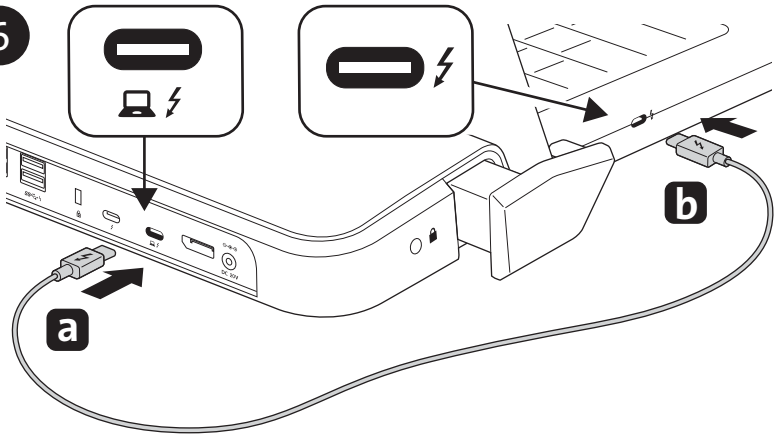

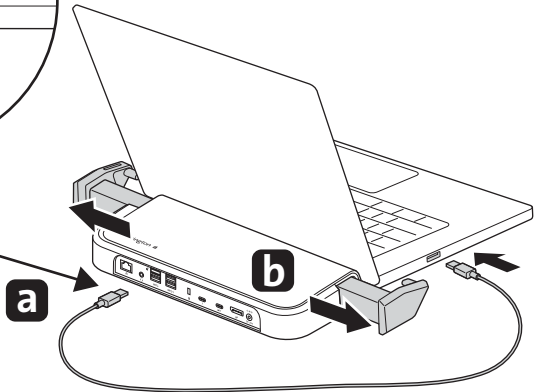
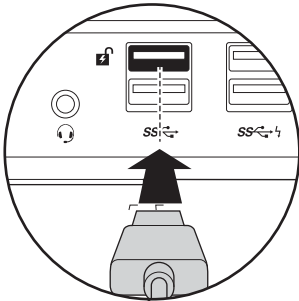
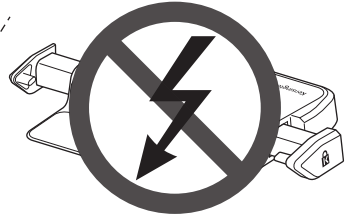
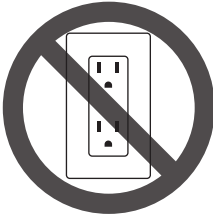

[www.kensington.com/support](http://www.kensington.com/support)



Australia	1300 881 931	México	55 15 00 57 00
België / Belgique	02 401 2395	Nederland	010 713 1882
Brasil	14 3235-4003	New Zealand	0800 539 26273
Canada	1 800 268 3447	Norway	80017520
中国	400 0684 219	Österreich	0800 677 873
Denmark	80 250966	Polska	22 570 18 00
Deutschland	0692 222 3654	Portugal	800855802
España	911 146 735	Россия	007 495 933 5163
Finland	0800 9 15697	Schweiz / Suisse	044 580 6667
France	01 7671 0404	Singapore	+65-6776-0195
Hong Kong	00852 2823 5130	Sweden	08 5033 6577
Hungary	06 20 9430 612	United Kingdom	0203 364 5390
Ireland	01 431 1395	United States	1 800 535 4242
Italia	02 3604 7030	International Toll	+31 53 484 9135
Japan	+81 04-7129-2135		

Kensington and ACCO are registered trademarks of ACCO Brands. All other registered and unregistered trademarks are the property of their respective owners.

© 2018 Kensington Computer Products Group, a division of ACCO Brands. Any unauthorized copying, duplicating, or other reproduction of the contents hereof is prohibited without written consent from Kensington Computer Products Group. All rights reserved. 06/18



**Kensington Computer Products Group**  
**A Division of ACCO Brands**  
 1500 Fashion Island Blvd, 3rd Floor  
 San Mateo, CA 94404



**ACCO Brands Europe**  
 A Division of ACCO Brands Europe  
 Oxford House, Oxford Road  
 Aylesbury, Buckinghamshire,  
 HP21 8SZ United Kingdom

**ACCO Brands Canada Inc**  
 7381 Bramalea Rd  
 Mississauga,  
 ON L5S 1C4  
 Canada

**ACCO Brands Australia - Kensington**  
 2 Coronation Avenue  
 Kings Park NSW 2148  
 Australia

**Importado por ACCO Mexicana S.A. de CV.**  
 Circuito de la Industria Norte # 6,  
 Corredor Industrial Toluca Lerma,  
 Lerma México Cp. 52004  
 R.F.C. AME640229-1W3

**Acco Brands Chile S.A.,**  
 Avda. Presidente Riesco # 5711,  
 oficina 201  
 Las Condes, Santiago,  
 Chile C.P. 7561114

**Importado e Distribuído por:**  
 Tilibra Produtos De Papelaria Ltda.  
 CNPJ: 44.990.901/0001-43  
 Rua Aymorés, 6-9 – Bauru/SP –  
 Brasil CEP 17013-900

**LEITZ ACCO Brands GmbH & Co KG**  
 Siemensstraße 64  
 70469 Stuttgart  
 Germany

**Dystrybutor:**  
 Essetle Polska Sp. z o.o.,  
 ul. Przemysłowa 11A,  
 26-900 Koźnice

**Dovozce/Dovozca:**  
 Essetle, s.r.o., V Lužich 818,  
 142 00 Praha 4,  
 Česka republika

**Forgalmazza:**  
 Essetle Kft, Vaci ut 76. V. torony I.  
 emelet, 1133 Budapest,  
 Magyarorszag

**Importator:**  
 Essetle Sales SRL, Gheorghe  
 Ţiţeica 121C, Sector 2, Bucureşti,  
 Romania

**ACCO Brands Asia Pte Ltd**  
 5A Toh Guan Road East #06-03,  
 Singapore 608830

广州市爱珂贸易有限公司  
 上海分公司  
 中国上海市长宁区  
 延安西路2299号1509室  
 电话: 021-61368966  
 传真: 021-61710161  
 www.accobrands.cn

アコ・ブランドズ・ジャパン株式会社  
 〒164-8721  
 東京都中野区本町1-32-2  
 ハーモニータワー14F  
 www.kensington.com/jp  
 JP.Kensington@acco.com

Designed in California, U.S.A. by Kensington  
 Made in China | Fabriqué en Chine | Fatta in Cina | Hecho en China |  
 Fabricado em China | Κατασκευάστηκε στην Κίνα |  
 Származási ország Kína | Fabricat in China | صنع في الصين