

TruSens

Z-2000

Owner's Guide

Air Purifier with SensorPod™ and  filtration



For rooms up to 375 square feet.

PLEASE READ AND SAVE THESE INSTRUCTIONS

This appliance has a polarized plug (one blade is wider than the other). To reduce the risk of electric shock, this plug is intended to fit in a polarized outlet only one way. If the plug does not fit fully in the outlet, reverse the plug. If it still does not fit, contact a qualified electrician. Do not attempt to defeat this safety feature.

Unplug or disconnect the appliance from the power supply before replacing filters or UV lamp, or when appliance is not in use.



WARNING: To reduce the risk of fire or electric shock, do not use this fan with any solid-state speed control device.

Do not operate any purifier with a damaged cord or plug, or if the wall socket is loose.

Do not run cord under carpeting, throw rugs, runners, or similar coverings. Do not run cord under furniture or appliances. Arrange cord away from traffic area and where it will not be tripped over.



WARNING: Skin or eye damage may result from directly viewing the light produced by the lamp in this apparatus. Always disconnect power before relamping or servicing. Replace lamp with UVLZ2000-01 (for Z-2000), or UVLZ3000-01 (for Z-3000), Manufactured by ACCO Brands.

- Remove all packaging, including the filter bag, before use.
- Appliances that are obviously damaged must not be operated.
- This appliance must only be connected to a wall socket outlet matching the supply plug type and rating stated on the rating plate.
- Locate air purifier near the outlet wall socket and do not use extension cords.
- This appliance can be used by children aged from 8 years and above and persons with reduced physical, sensory or mental capabilities or lack of experience and knowledge if they have been given supervision or instruction concerning use of the appliance in a safe way and understand the hazards involved.
- Children shall not play with the appliance.
- Replace the UV lamp with the models specified within this manual.
- Do not attempt to service or repair this product yourself.
- Only use the purifier and SensorPod™ with the power cable provided.
- Only clean this machine with a damp cloth, do not use solvents or bleach.
- Ensure appliance is always placed on firm level surface before operation.
- Do not block or obstruct the air intake or outlet vents.
- Do not insert fingers or other items into the air intake or outlet vents.
- When the air purifier is in standby mode the Sensor pod is still transmitting a signal/data.

Z-2000: FCC ID: GV3-18Z2000 IC: 6128A-18Z2000

Z-3000: FCC ID: GV3-18Z3000 IC: 6128A-18Z3000

Sensor: FCC ID: GV3-18SP001 IC: 6128A-18SP001

This device complies with part 15 of the FCC Rules. Operation is subject to the following two conditions:

(1) This device may not cause harmful interference, and

(2) this device must accept any interference received, including interference that may cause undesired operation.

Any Changes or modifications not expressly approved by the party responsible for compliance could void the user's authority to operate the equipment.

This equipment has been tested and found to comply with the limits for a Class B digital device, pursuant to Part 15 of the FCC Rules. These limits are designed to provide reasonable protection against harmful interference in a residential installation. This equipment generates, uses and can radiate radio frequency energy and, if not installed and used in accordance with the instructions, may cause harmful interference to radio communications.

However, there is no guarantee that interference will not occur in a particular installation. If this equipment does cause harmful interference to radio or television reception, which can be determined by turning the equipment off and on, the user is encouraged to try to correct the interference by one or more of the following measures:

Reorient or relocate the receiving antenna.

Increase the separation between the equipment and receiver.

Connect the equipment into an outlet on a circuit different from that to which the receiver is connected.

Consult the dealer or an experienced radio/TV technician for help.

FCC RF Radiation Exposure Statement: This equipment should be installed and operated with minimum distance of 20cm between the radiator and all persons.

This device contains licence-exempt transmitter(s)/receiver(s) that comply with Innovation, Science and Economic Development Canada's licence-exempt RSS(s). Operation is subject to the following two conditions:

(1) This device may not cause interference.

(2) This device must accept any interference, including interference that may cause undesired operation of the device.

Experience the difference

Congratulations! We are thrilled to be part of your health and wellness journey and take pride in the functionality and design of your TruSens™ air purifier.



SensorPod™

Remote air quality monitor that ensures cleaner air, right where you need it



PureDirect™ technology

Two airflow streams are better than one, moving air effectively and more comfortably throughout the room.



Informs and adapts

Color-coded illuminated ring provides additional information by communicating air quality in real-time



360° Purification

 HEPA filter captures pollutants and VOC gases/odors from all directions. UV light kills germs and bacteria that can get trapped in the filter.



Thoughtful execution

Exceptional functionality wrapped in a contemporary design that fits any environment

Manual Contents

Getting Started	4
Product Overview	5
Control Panel	7
Air Quality Display	7
Specifications	8
Care and Maintenance	
Replacing HEPA Filter	9
Replacing Carbon Filter	10
Washing the Prefilter	10
Replacing the UV lamp	11
Cleaning the SensorPod	12
Frequently Asked Questions	13
Pairing the SensorPod	14
Support	15
Warranty	15



Getting started

- ! Step 1. Remove plastic bag from filter**
Unscrew the bottom cover and remove the plastic bag from the filter.

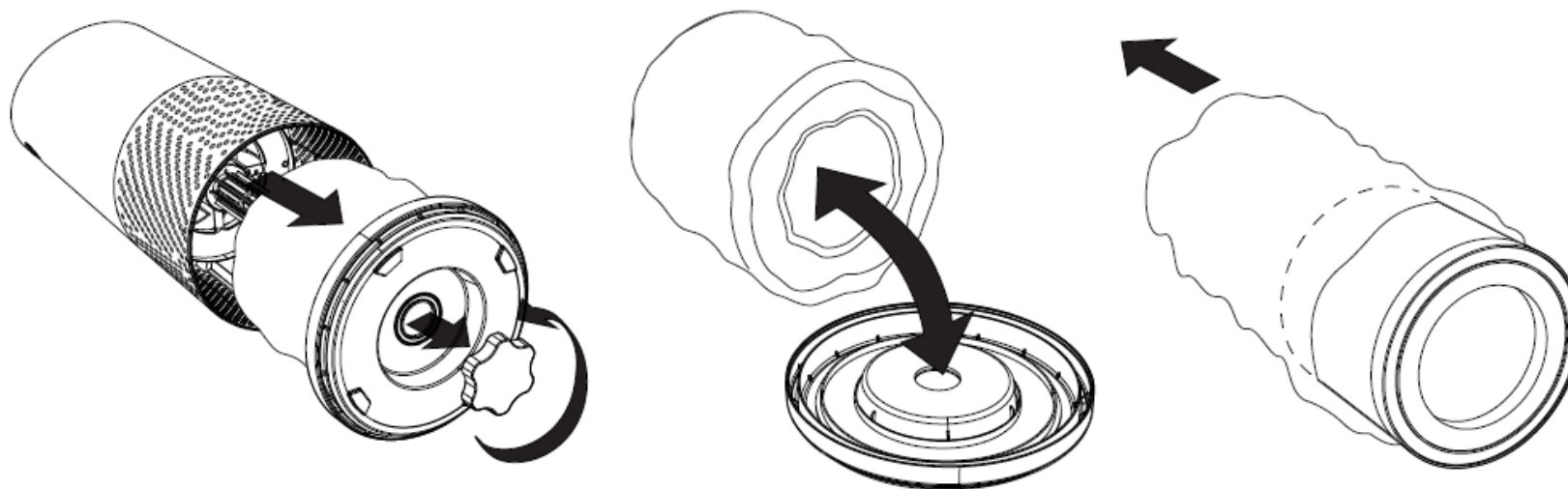

Step 2. Re-attach filter

Secure filter on the bottom cover and replace inside the purifier.

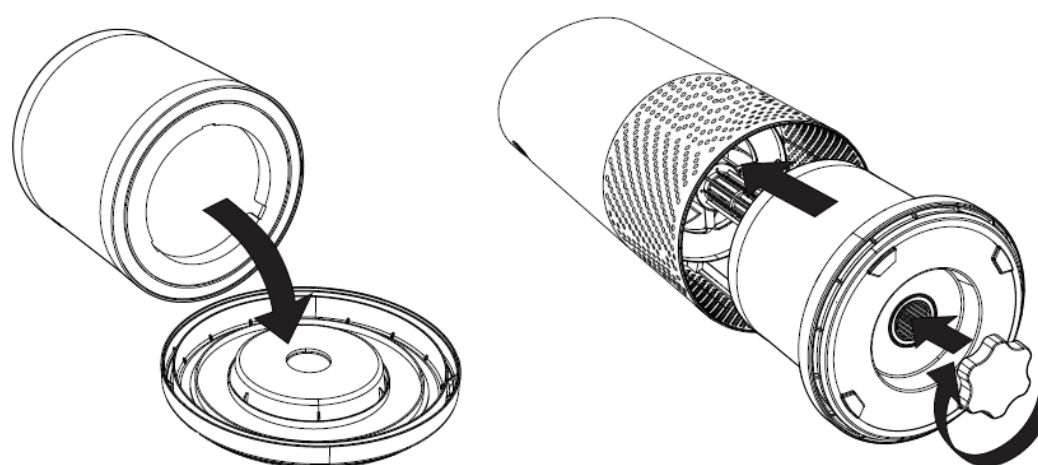

Step 3. Set up

Plug-in your air purifier unit and power on.

Place the purifier on a flat surface, free from obstructions

Plug-in your SensorPod.

Place SensorPod upright on tabletop or counter across the room, within line of sight of the purifier.
Signal strength may vary by location. In the rare occasion that it doesn't work – see page 14.

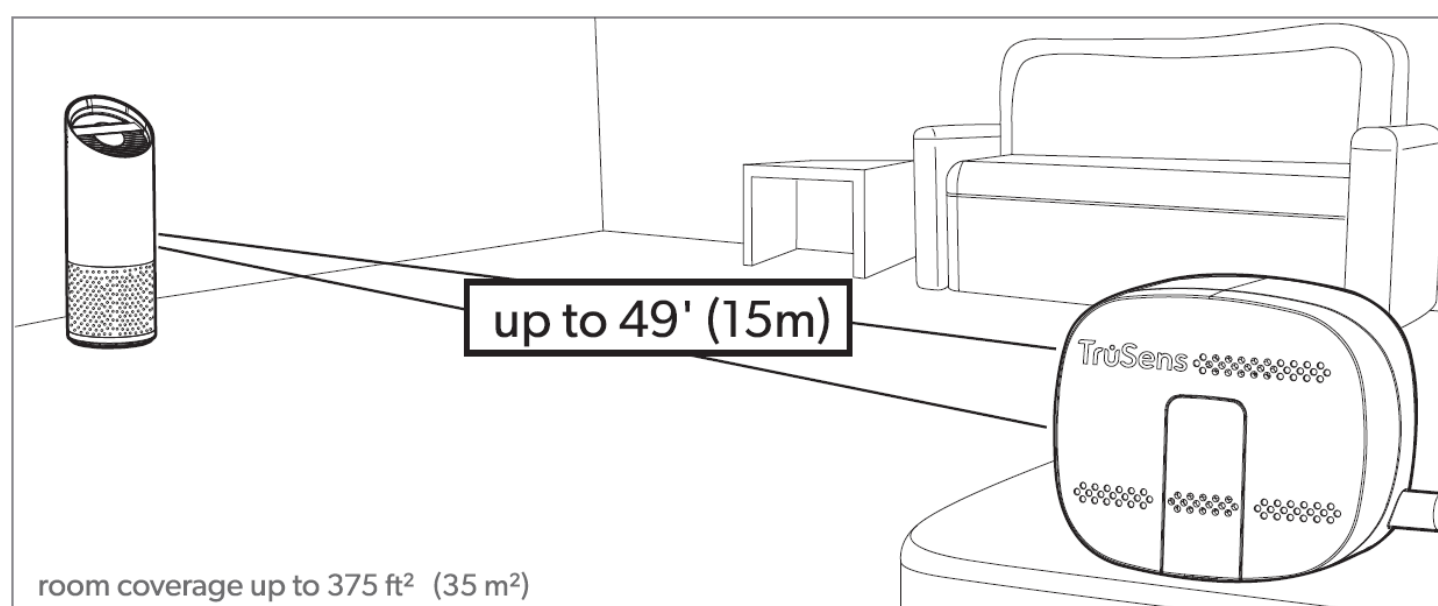

Start living with cleaner air!

The purifier will automatically adjust fan speeds based on the air quality readings from SensorPod, and proprietary PureDirect technology will deliver purified air throughout the room!

Get to know your air purifier



1. Easy-carry handle
2. Simple touch control panel
3. Air quality indicator display
4. 360° air intake
5. Filter chamber cover & knob (underneath)

Get to know your SensorPod™

The separate air quality sensor can more accurately represent the air quality in your room by monitoring the air **away** from the purifier, ensuring greater coverage of cleaner air.

Infrared light detects both small (PM2.5) and large (PM10) particulate matter, and communicates the conditions of your air back to the purifier.

1. Power and Signal Indicator
2. Air outlet
3. Air inlet
4. Easy-access door, for cleaning sensor

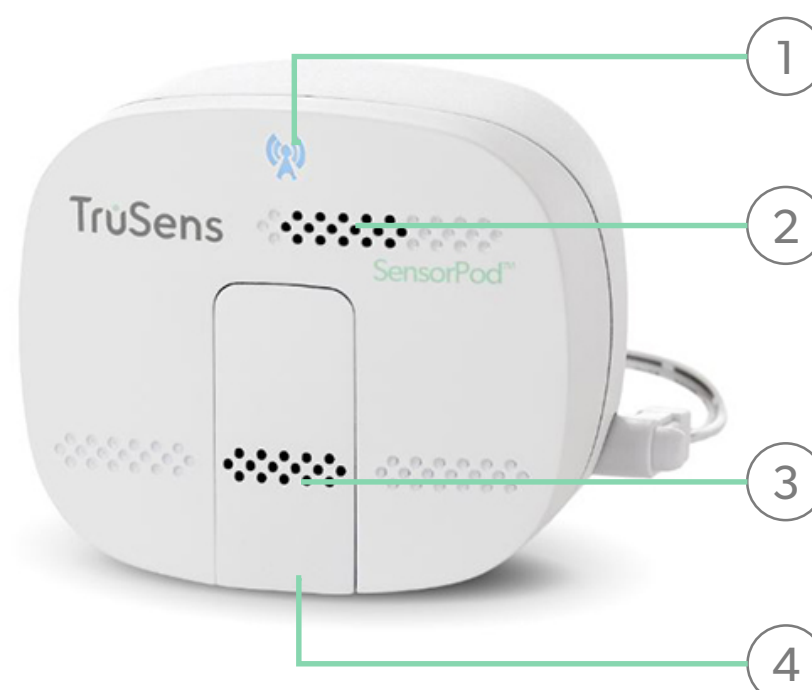

PureDirect™ cleans comfortably and effectively

Independent lab testing of different airflow configurations confirms that dual airflow can distribute air further and more evenly throughout the room.

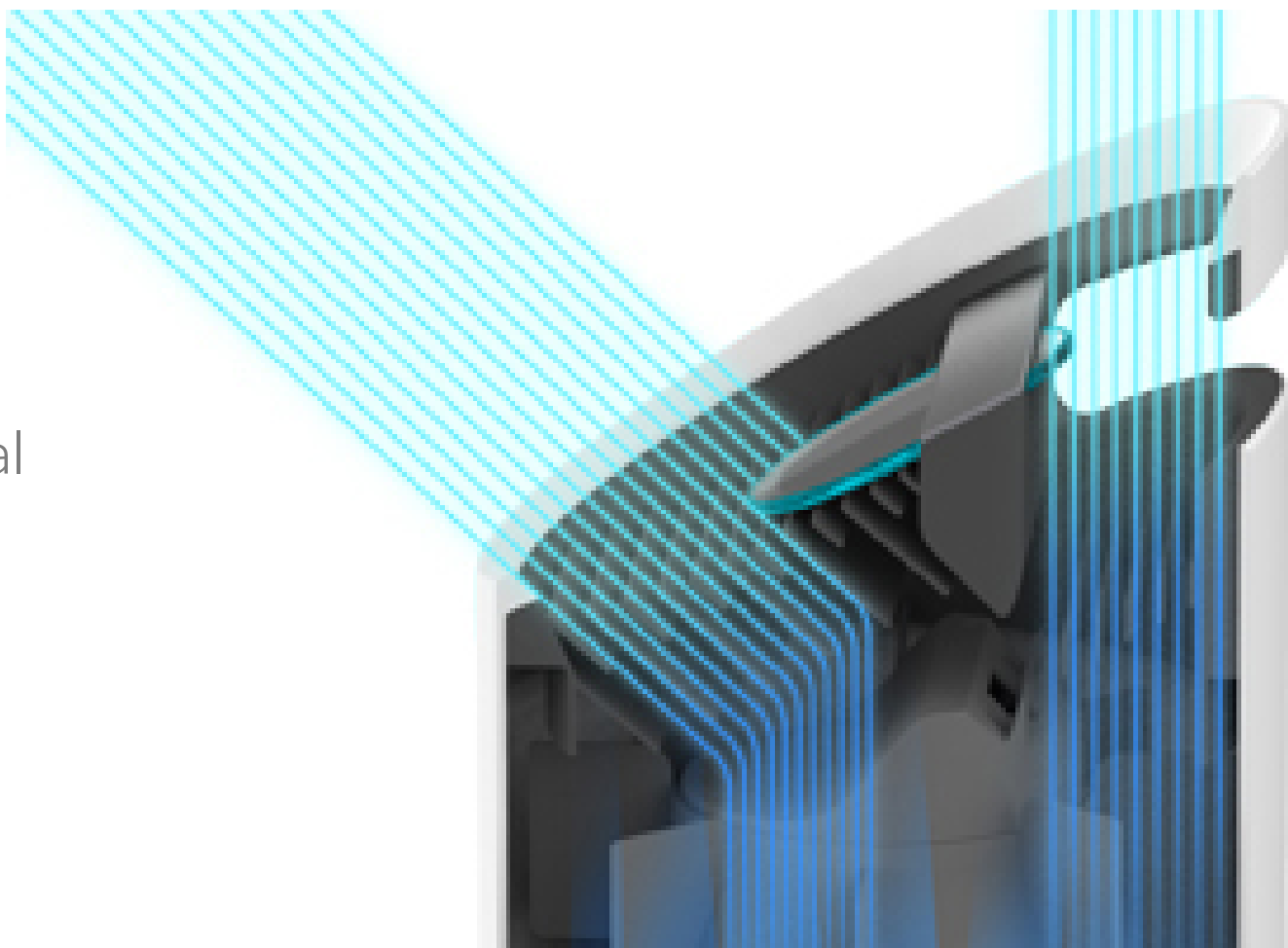

filtration and UV sterilization

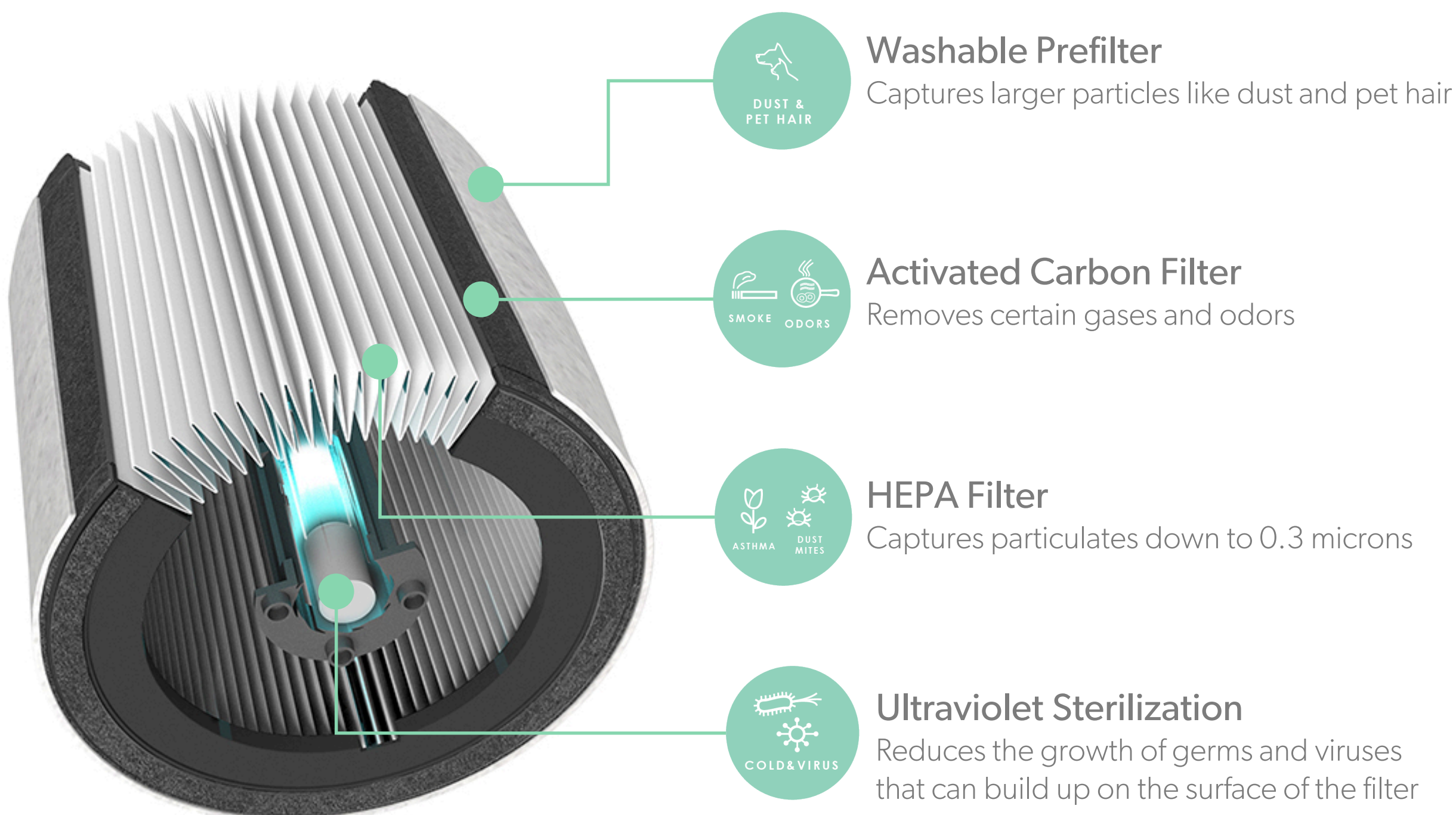

Directions for changing the filters and UV on pages 9-11.

Control Panel



Power Button



Fan Speed Settings

Select fan speed or AUTO mode.

In AUTO mode, purifier automatically adjusts fan speed based on air quality readings from SensorPod.

(AUTO mode only available when purifier is paired with SensorPod and receiving signal.)



Dimmer Mode

Display illumination turns off – for use while sleeping – without sacrificing the effectiveness of the purifier.

Simply press the button again to bring back all display features.



Timer Mode

Purifier will automatically turn off after 2, 4, 8, or 12 hours.

To cancel this countdown, simply press button until no timer setting is displayed.



UV Mode

UV lamp within the purifier's filter chamber is on when  symbol is white.

 symbol will glow red when it is time to replace the UV lamp. *See page 11 for instructions.*



Filter and UV Indicator Reset

HEPA, Carbon, and UV indicators glow red when it is time for each to be replaced. *See pages 9-11 for instructions.*

When 1 indicator is on, simply hold Reset button for 3 seconds to reset that indicator.

When 2+ indicators are on, press the Reset button to select the correct indicator (selected indicator will blink) before holding 3 seconds to reset that indicator.

Real-time air quality feedback

The revolutionary SensorPod evaluates the condition of your air by measuring both small (PM2.5) and larger (PM10) particulate matter. It calculates the overall air quality using a proprietary algorithm that is reactive to genuine increases in pollutants without overreacting to someone entering the room or settling into the couch.

The illuminated, color-coded display communicates good, moderate or poor air quality and a numeric value provides a greater level of detail.

In AUTO mode, TruSens automatically adjusts the fan speed in response to these air quality readings.



Good
0 - 50



Moderate
50 - 100



Poor
100 - 500



TruSens utilizes the Air Quality Index (1-500) created by the U.S. Environmental Protection Agency (EPA).

Specifications

Air Inlet	360°
Air changed 2 times per hour	375 ft² (35 m²)
Air Delivery Type	PureDirect™
Sensor	SensorPod™ Works up to 49 ft (15 m) across a room from the purifier.
Fan Speed Settings	Whisper, 1, 2, Turbo
Purification Levels	Washable Prefilter Carbon HEPA Type UV
Timer Settings	2, 4, 8, 12 hour
Filter Change Indicator Type	Carbon, HEPA, UV
Noise	33 - 64 dB
Dimensions	8.8" x 8.8" x 22.3" 223 x 223 x 567 mm
Weight	9.0 lbs (4.1 kg)
Motor Type	DC motor
Power Requirements	120v / 60 Hz
Power Consumption	28 W
Warranty	2 years
Replacement Filters and UV Lamps	
360° filter (Prefilter, HEPA, Carbon)	AFH-Z2000-01
Carbon filter (3-pack)	AFC-Z2000-01
Ultraviolet Lamp	UVL-Z2000-01



Filter Change and Maintenance

Accessing the filter chamber

1. Always power off the purifier by pressing the Power Button and unplugging the power cord.
2. Gently place the unit on its side on the floor so that the filter chamber cover and knob are exposed.
3. Turn the knob counter-clockwise and remove the filter chamber cover and 360° HEPA filter drum (Fig. A).

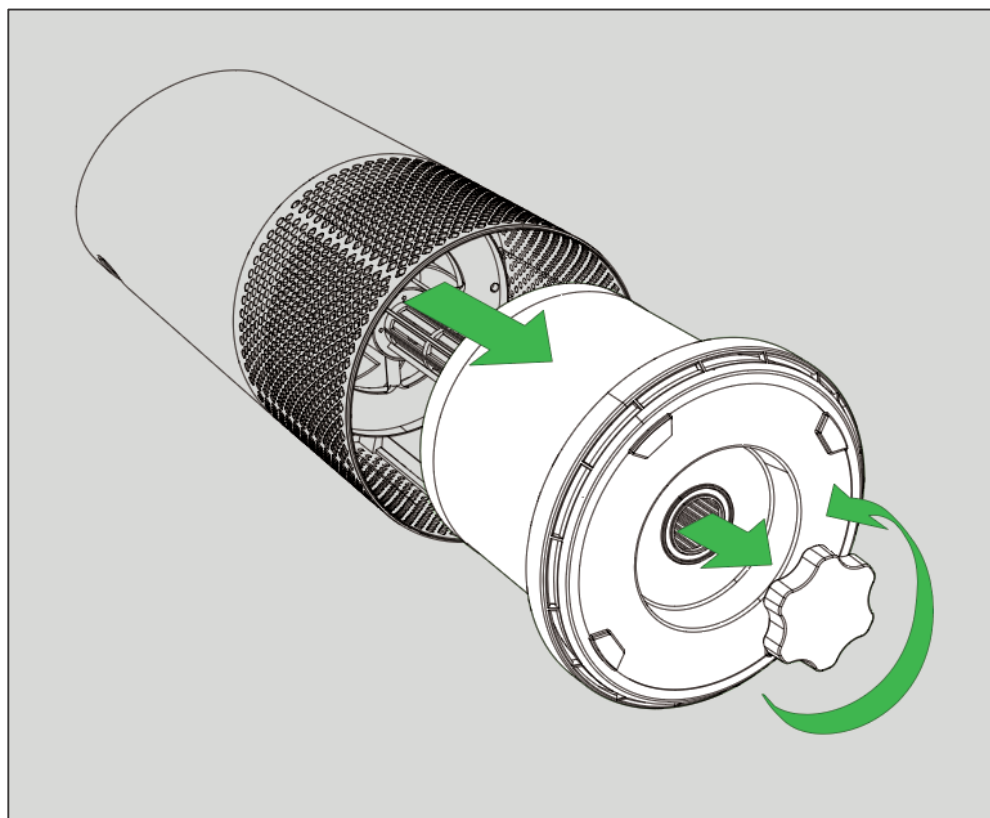

Fig. A

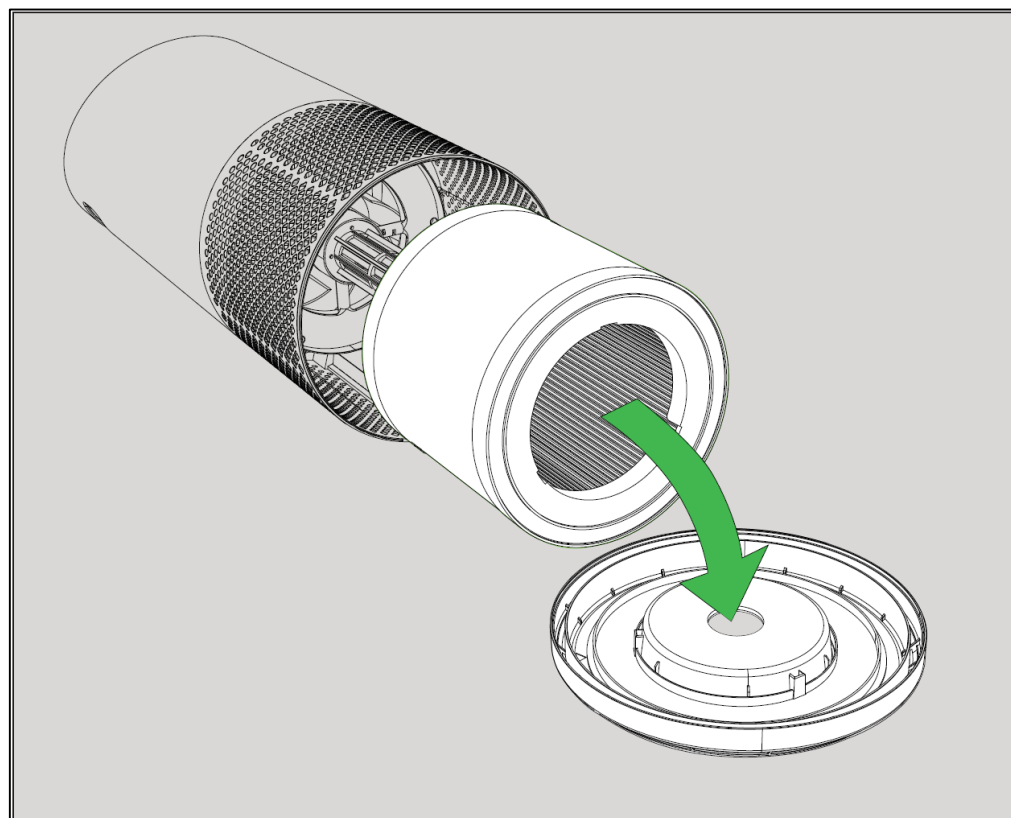

Fig. B

Replacing the 360° HEPA drum filter

1. The HEPA indicator will glow red when it is time to change the entire HEPA drum filter.
2. Gently pull the HEPA drum filter away from its place secured to the filter chamber cover (Fig. B).
3. Your replacement HEPA filter (*on page 8*) will include all layers: Washable Prefilter, Carbon, and HEPA.
4. Secure the replacement HEPA filter onto the filter chamber cover (Fig. C).
5. Gently replace the filter drum and filter cover into the filter chamber and onto the threading, and turn the knob clockwise until the knob and filter chamber cover are securely tightened (Fig. D).
6. After plugging-in and powering-on the purifier, hold the Reset button until the red HEPA indicator turns off.

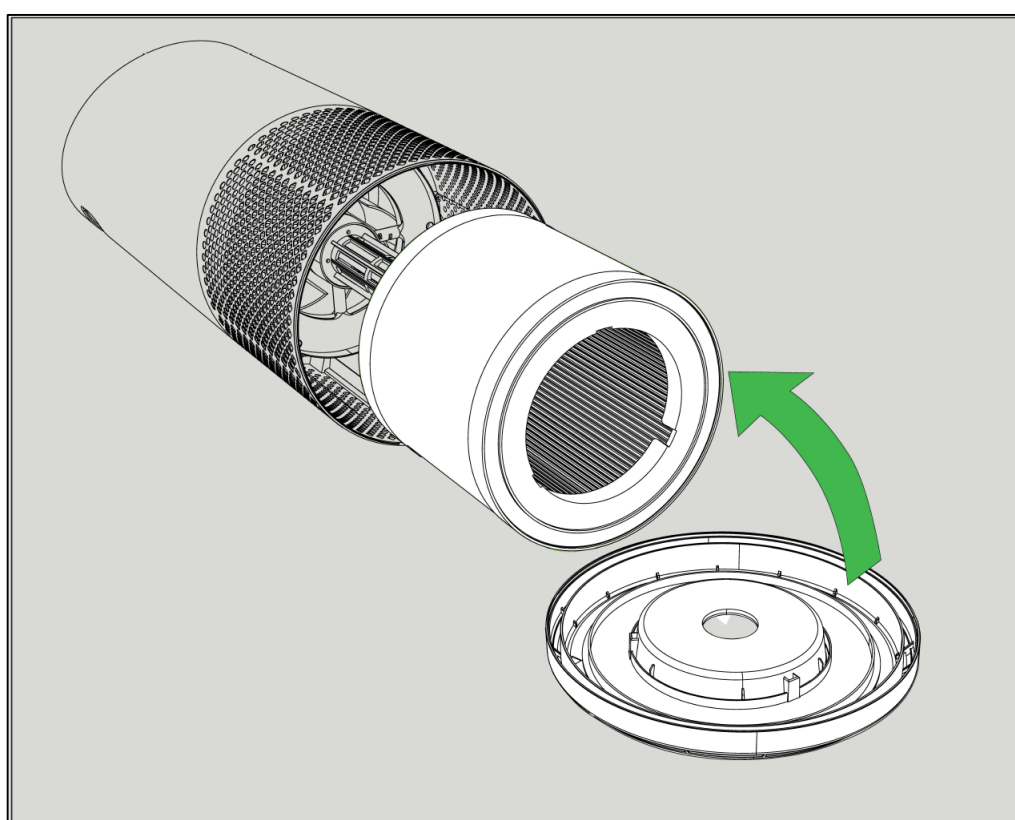

Fig. C

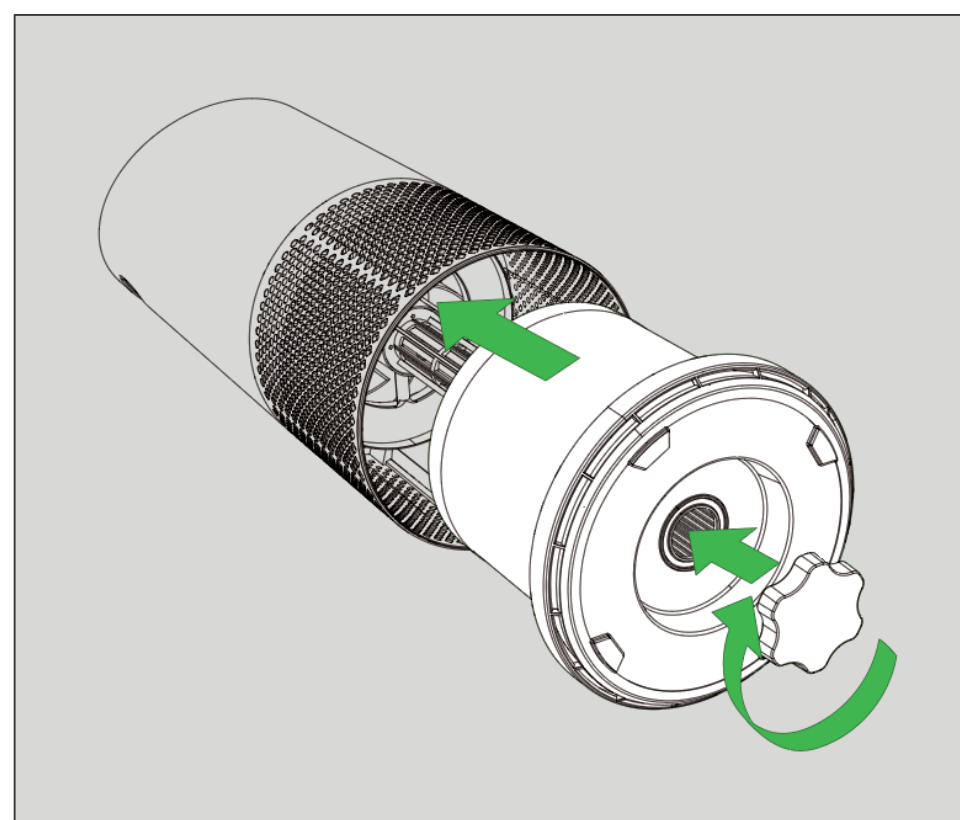

Fig. D

Replacing the Carbon filter

1. The Carbon indicator will glow red when it is time to replace the Carbon layer.
2. Gently peel away the Prefilter from its fastener strips (Fig. E).
3. Gently peel away the used Carbon layer from its fastener strips (Fig. F).
4. Your replacement 3-pack of Carbon filters (*on page 8*) will cover each of the three Carbon changes between changes of the entire HEPA drum filter assembly (*see page 9*).
5. Wrap a new Carbon layer around the filter drum and attach using the same fastener strips (Fig. G).
6. Replace the Prefilter by wrapping it around the Carbon layer and attach using its fastener strips (Fig. H).
7. Once the purifier is powered-on, hold the Reset button until the red Carbon indicator turns off.

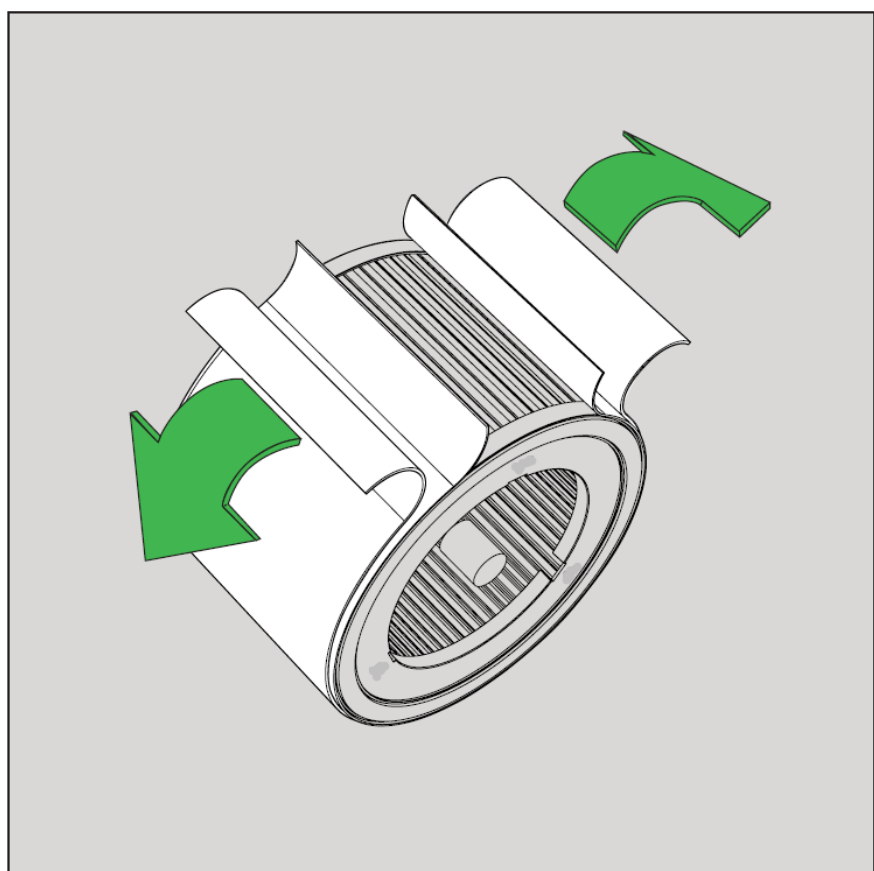

Fig. E

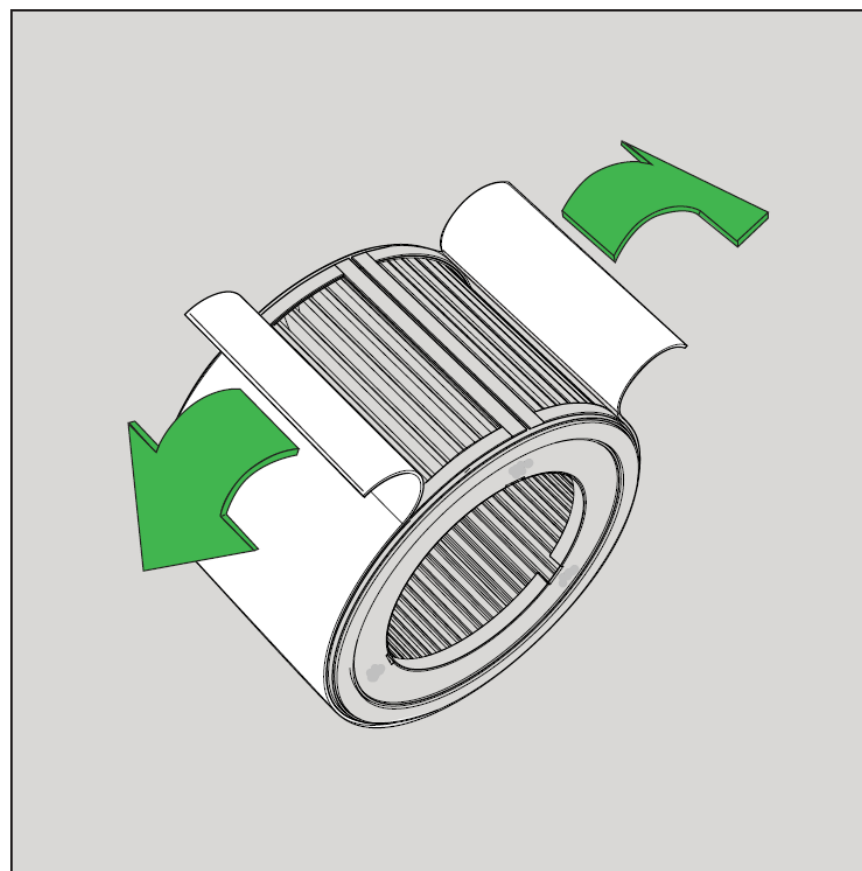

Fig. F

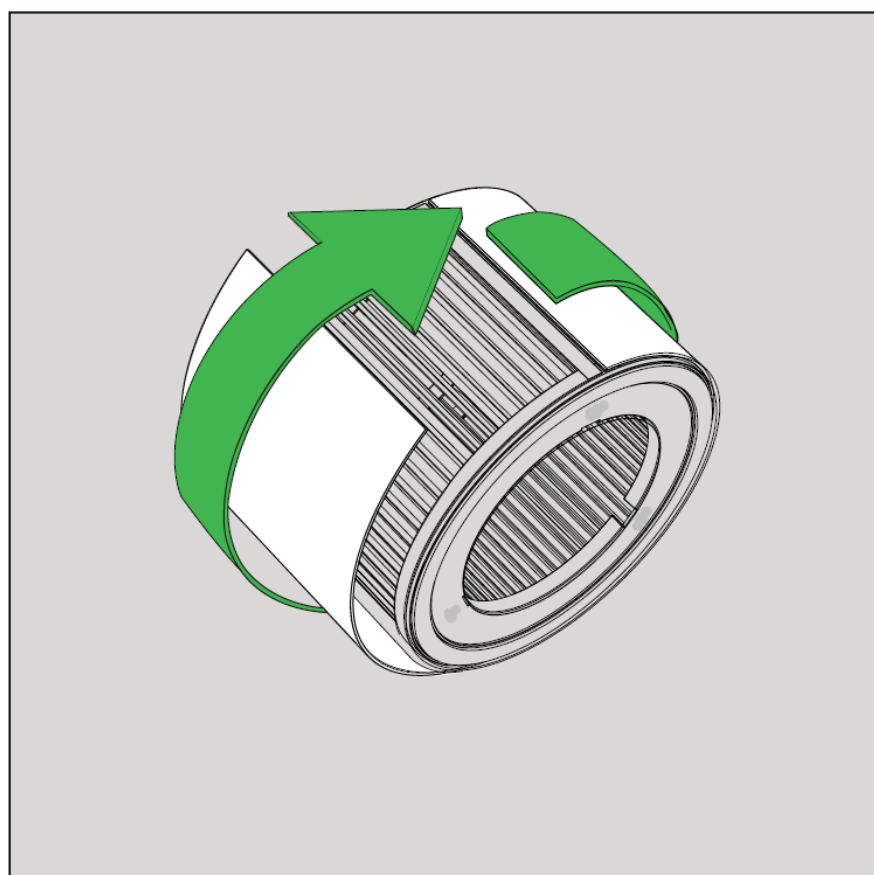

Fig. G

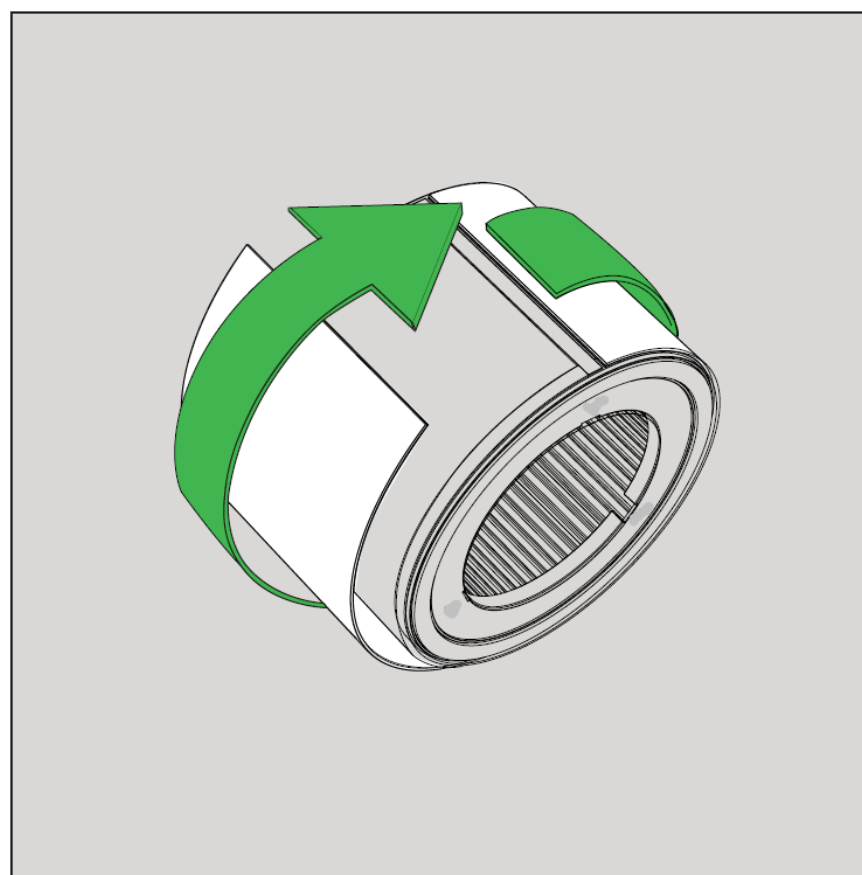

Fig. H

Hand washing the Prefilter *(Please Note: HEPA & Carbon filters are not washable)*

1. We recommend that you visually inspect the Prefilter every month, and clean as needed. At minimum, you should hand wash the Prefilter every time you change the Carbon or HEPA filters.
2. Gently peel away the Washable Prefilter from its fastener strips (Fig. E).
3. Gently rinse with running water – allow Prefilter to air dry before re-installing.
4. Replace the Prefilter by wrapping it around the filter drum and attach using its fastener strips (Fig. H).

Replacing the UV lamp



1. The  indicator will glow red when it is time to replace the UV lamp.
2. Remove filter drum (Fig. A), and use a screwdriver to remove the screw securing the UV housing (Fig. I).
3. Gently remove UV housing (Fig. J) and release UV lamp from carriage (Fig. K).
4. Disconnect UV lamp clip from socket (Fig. L) and replace by connecting new UV lamp *(on page 8)*.
5. Secure UV lamp into carriage (Fig. M) and re-install carriage into purifier (Fig. N).
6. Replace the UV housing (Fig. O) and use a screwdriver to tighten the fastening screw (Fig. P).
7. Once the purifier is powered-on, hold the Reset button until the  indicator turns white.



Fig. I

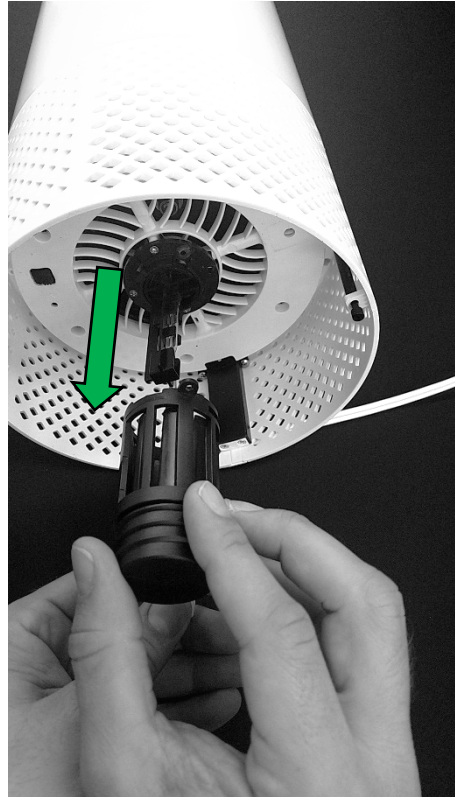

Fig. J

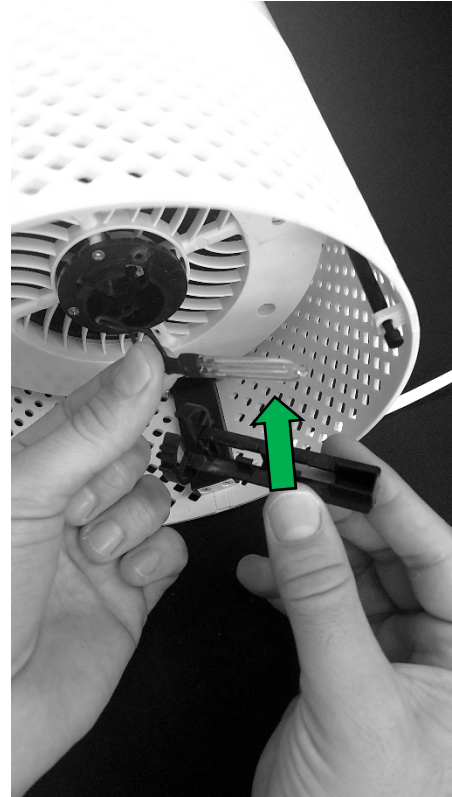

Fig. K



Fig. L

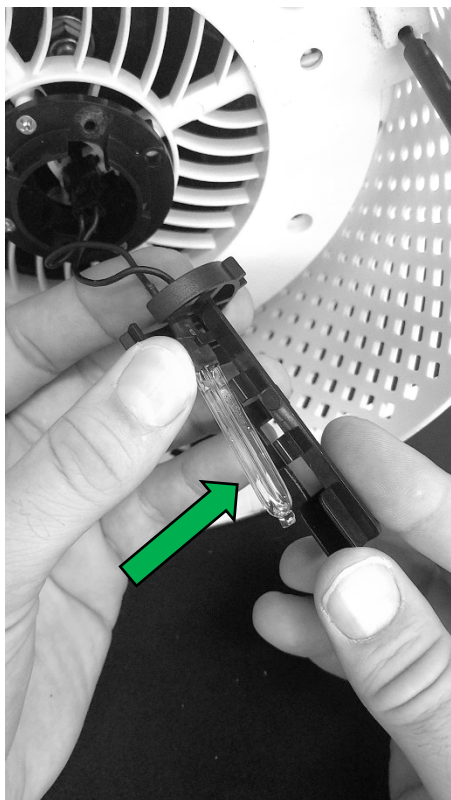

Fig. M



Fig. N



Fig. O



Fig. P

Cleaning the air quality sensor within the SensorPod™

The SensorPod uses an infrared light to detect particulate matter, so it is important that you clean the viewing chamber every 1-2 months to remove any dust or particles that may affect the accuracy of the sensor's readings.

1. Turn-off the SensorPod by unplugging the power cord.
2. Open the cover on the front side by sliding the door downward and rotating outward at a 90° angle.
3. Use a damp cotton swab to wipe the lens and intake area of the dust sensor (Fig. Q).
4. Use a dry cotton swab to wipe away any remaining moisture.
5. Close the cover by rotating the door back down and sliding it back into place until you hear a click.

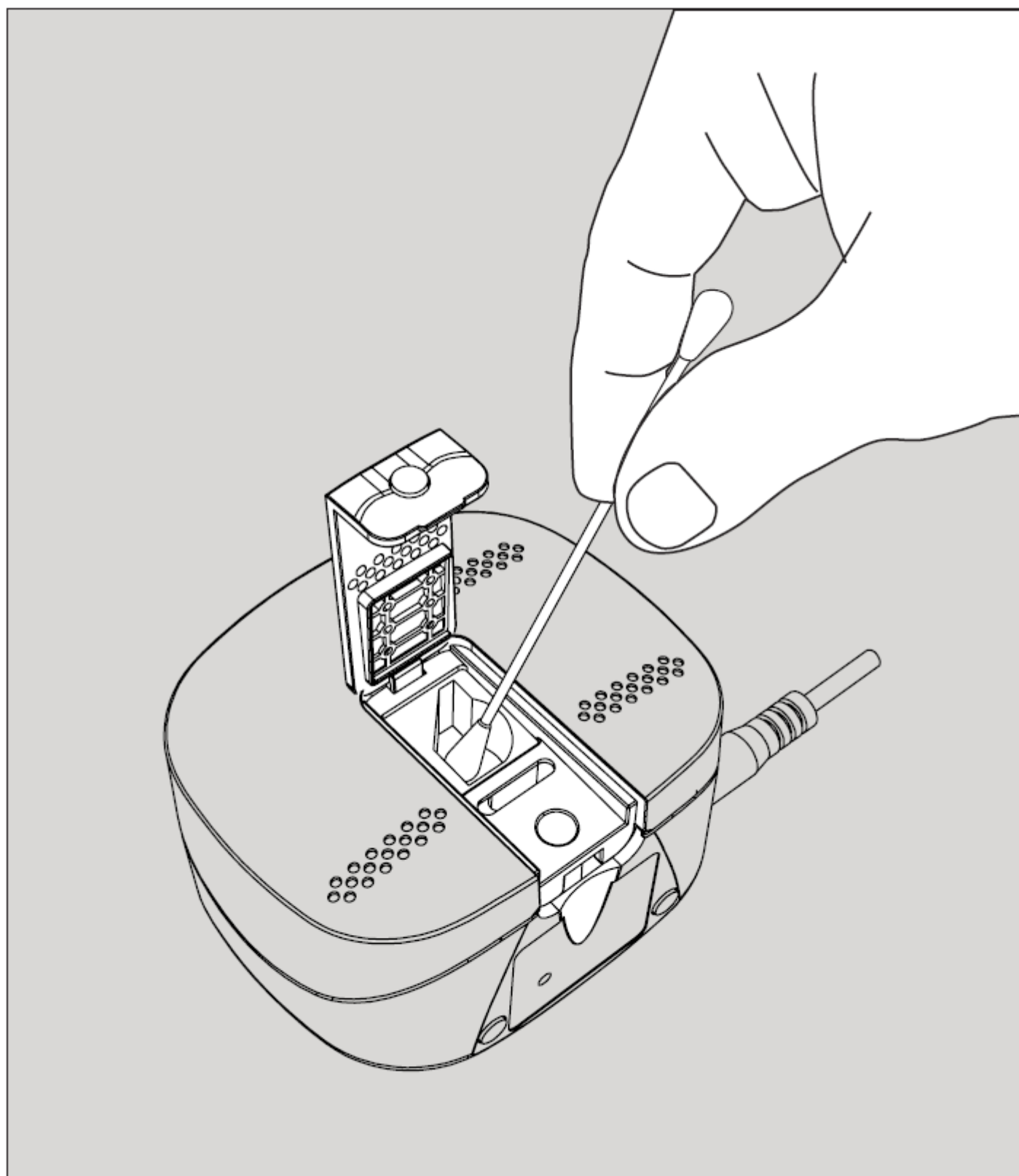

Fig. Q

Troubleshooting and FAQ

Where do I place the SensorPod?	<p>Anywhere you want to measure the air quality within the room!</p> <p>For optimal results, place the SensorPod away from the air purifier on a counter or table, within line of sight of the purifier.</p> <p>In Auto Mode, the purifier will work to distribute clean air until the SensorPod reads an acceptable level of air quality.</p> <p><i>See specification table on page 8 for appropriate room sizes for each model.</i></p>
How often do I need to change the filters?	<p>That's easy! The purifier's replacement indicators will notify you when it is time to replace the Carbon or HEPA filters, or the UV lamp.</p> <p>Plan on replacing the Carbon every 3-4 months, HEPA every 12-15 months, and UV lamp every 1-3 years.</p>
How often do I need to wash the Prefilter?	<p>The Prefilter captures larger particles and preserves the efficiency of the other filters, so we recommend that you visually inspect the prefilter every month and wash as needed. Another good habit is to wash the prefilter every time you replace a filter or the UV lamp.</p>
How often do I need to clean the dust sensor within SensorPod?	<p>For the most accurate measurement of your air quality, we'd recommend you clean the surface of the dust sensor every 1-2 months.</p>
Purifier won't turn on.	<p>Check that the power cord is connected securely to both the wall outlet and the purifier. Check if there is a power outage in the outlet by trying a nearby light or device or by trying a working device in the same outlet. Check that the HEPA filter is fitted properly into filter chamber.</p> <p>Please contact us if you're still having a problem! <i>(page 15)</i></p>
<div>Purifier won't go into Auto Mode.</div> <div>or</div> <div>Air quality indicators are off.</div> <div>or</div> <div>Purifier's sensor signal indicator is blinking.</div>	<p>Auto Mode is only available when the purifier can react to air quality readings from the SensorPod, so check that the SensorPod is plugged-in and that its light is solid.</p> <p>The air quality indicators are based on readings from the SensorPod, and the purifier's sensor strength indicator will blink if there are any issues with the connection.</p> <p><i>See page 14 for instructions on repairing the SensorPod's connection.</i></p>
I've lost my SensorPod!	<p>Don't worry! Please contact our customer support team and you can order a replacement SensorPod. Follow the easy pairing process on page 14 for pairing your replacement SensorPod with your existing air purifier!</p>





Troubleshooting and FAQ

Pairing SensorPod™ and Purifier

The SensorPod communicates with the purifier using radio frequency signals, and will be paired on the production line and ready for use when you open the box.

Signal strength may vary by location, but in the rare event that the signal is interrupted, you can repair the connection in just a few easy steps.

You'll know that the signal is lost because the purifier's sensor indicator light  will blink if the SensorPod is unplugged or out of range.

1. Unplug the SensorPod.
2. HOLD the Power Button on the purifier for 3 seconds, when you should hear two chimes.
3. Plug-in the SensorPod and use an item with a small point (paper clip) to press and HOLD the pairing button underneath the SensorPod for 3 seconds (Fig. R).
4. The connection should be established. You'll know because the purifier's sensor indicator light  will be lit with no blinking, and the air quality indicators should be on.

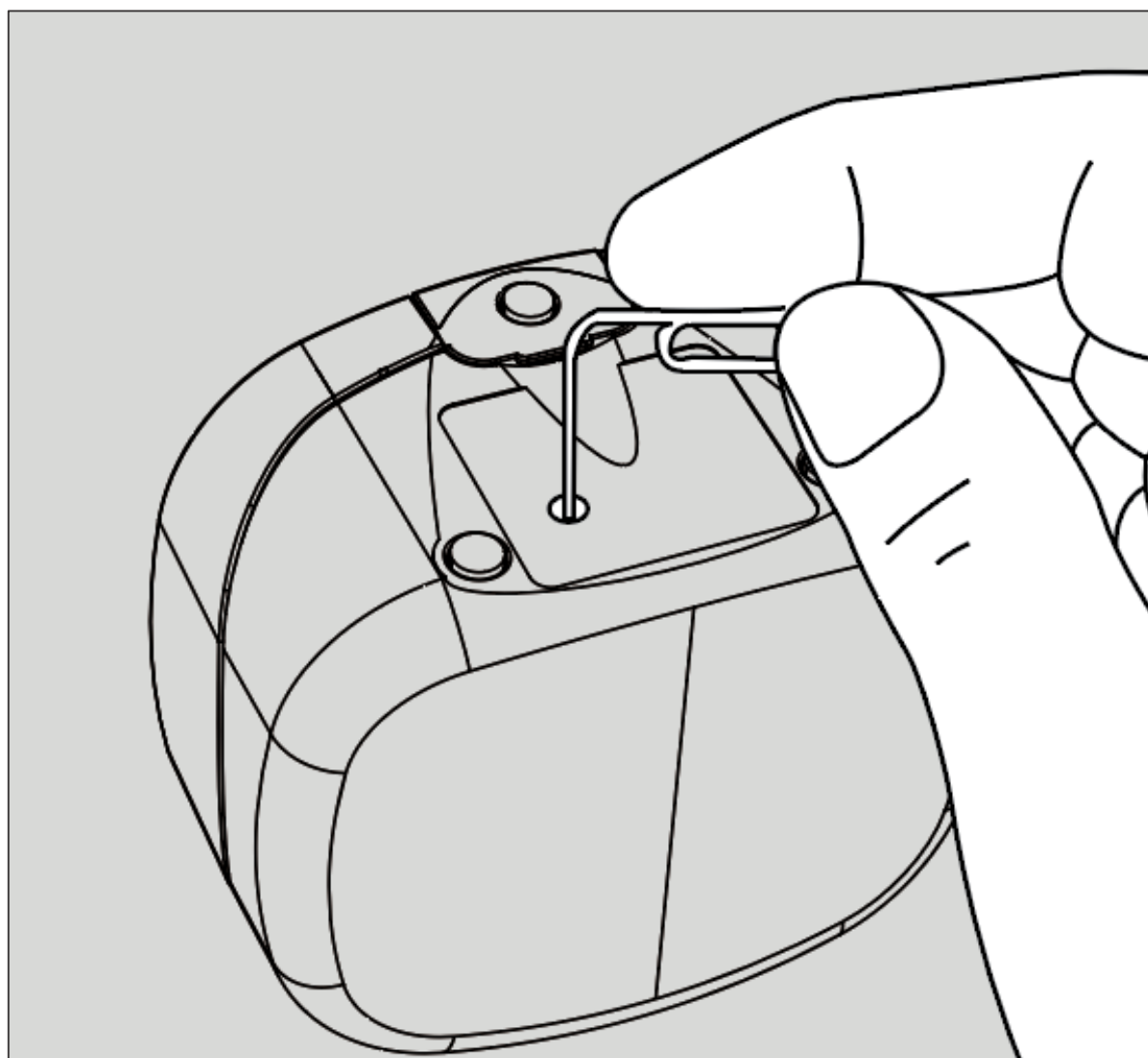

Fig. R

Support

Thank you for welcoming TruSens™ into your home. Our customers are at the heart of what we do, and we strive to design products that fit your lifestyle. If you have any questions or feedback, please reach out!



Visit our website at www.trusens.com



Email us at support@trusens.com



Call us at **1-833-TRUSENS**
(1-833-878-7367)

And visit us and share your experience with us on social media!



/TruSensWellness



@Tru_Sens



@tru_sens



TruSens

Warranty

TruSens warrants that the machine will be perform to the specifications stated and be free from defects in materials and workmanship for a period of 2 years from date of purchase, subject to normal use. Within the guarantee period, TruSens will at its own discretion either repair or replace the defective machine free of charge. Defects due to shipping, misuse, improper maintenance or the use of any parts from another manufacturer are not covered under this guarantee. Proof of date of purchase will be required. Repairs or alternations made by persons not authorized by TruSens will invalidate the guarantee. This guarantee does not affect the legal rights which consumers have under applicable national legislation governing the sale of goods.



Experience the difference

www.trusens.com