

TruSens

Z-1000

Owner's Guide

Air Purifier with  filtration



For rooms up to 250 square feet.

PLEASE READ AND SAVE THESE INSTRUCTIONS

This appliance has a polarized plug (one blade is wider than the other). To reduce the risk of electric shock, this plug is intended to fit in a polarized outlet only one way. If the plug does not fit fully in the outlet, reverse the plug. If it still does not fit, contact a qualified electrician. Do not attempt to defeat this safety feature.

Unplug or disconnect the appliance from the power supply before replacing filters or UV lamp, or when appliance is not in use.

 **WARNING:** To reduce the risk of fire or electric shock, do not use this fan with any solid-state speed control device. Do not operate any purifier with a damaged cord or plug, or if the wall socket is loose. Do not run cord under carpeting, throw rugs, runners, or similar coverings. Do not run cord under furniture or appliances. Arrange cord away from traffic area and where it will not be tripped over.

 **WARNING:** Skin or eye damage may result from directly viewing the light produced by the lamp in this apparatus. Always disconnect power before relamping or servicing. Replace lamp with UVLZ1000-01, Manufactured by ACCO Brands.

- Remove all packaging, including the filter bag, before use.
- Appliances that are obviously damaged must not be operated.
- This appliance must only be connected to a wall socket outlet matching the supply plug type and rating stated on the rating plate.
- Locate air purifier near the outlet wall socket and do not use extension cords.
- This appliance can be used by children aged from 8 years and above and persons with reduced physical, sensory or mental capabilities or lack of experience and knowledge if they have been given supervision or instruction concerning use of the appliance in a safe way and understand the hazards involved.
- Children shall not play with the appliance.
- Replace the UV lamp with the models specified within this manual.
- Do not attempt to service or repair this product yourself.
- Only use the purifier with the power cable provided.
- Only clean this machine with a damp cloth, do not use solvents or bleach.
- Ensure appliance is always placed on firm level surface before operation.
- Do not block or obstruct the air intake or outlet vents.
- Do not insert fingers or other items into the air intake or outlet vents.

Experience the difference

Congratulations! We are thrilled to be part of your health and wellness journey and take pride in the functionality and design of your TruSens™ air purifier.



PureDirect™ technology

Two airflow streams are better than one, moving air effectively and more comfortably throughout the room.



360° Purification

 HEPA filter captures pollutants and VOC gases/odors from all directions. UV light kills germs and bacteria that can get trapped in the filter.



Thoughtful execution

Exceptional functionality wrapped in a contemporary design that fits any environment.

Manual Contents

| | |
|----------------------------|----|
| Getting Started | 4 |
| Product Overview | 5 |
| Control Panel | 6 |
| Specifications | 6 |
| Care and Maintenance | |
| Replacing HEPA Filter | 7 |
| Replacing Carbon Filter | 8 |
| Replacing the UV lamp | 8 |
| Frequently Asked Questions | 9 |
| Support | 10 |
| Warranty | 10 |

Getting started



Step 1. Remove plastic bag from filter

Unscrew the bottom cover and remove the plastic bag from the filter.

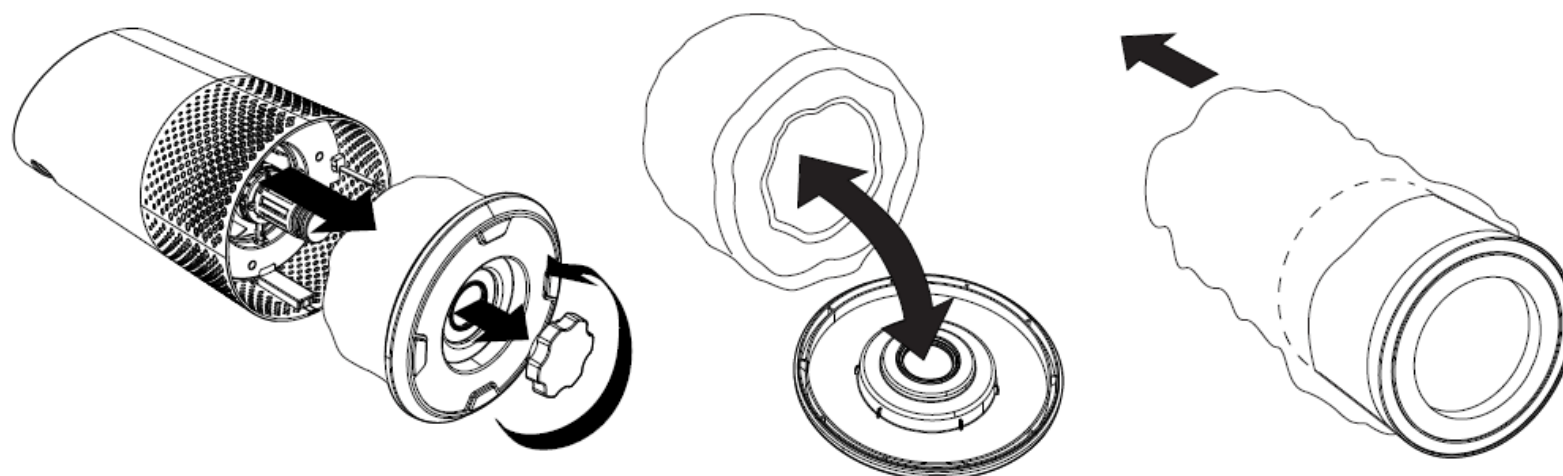

Step 2. Re-attach filter

Secure filter on the bottom cover and replace inside the purifier.

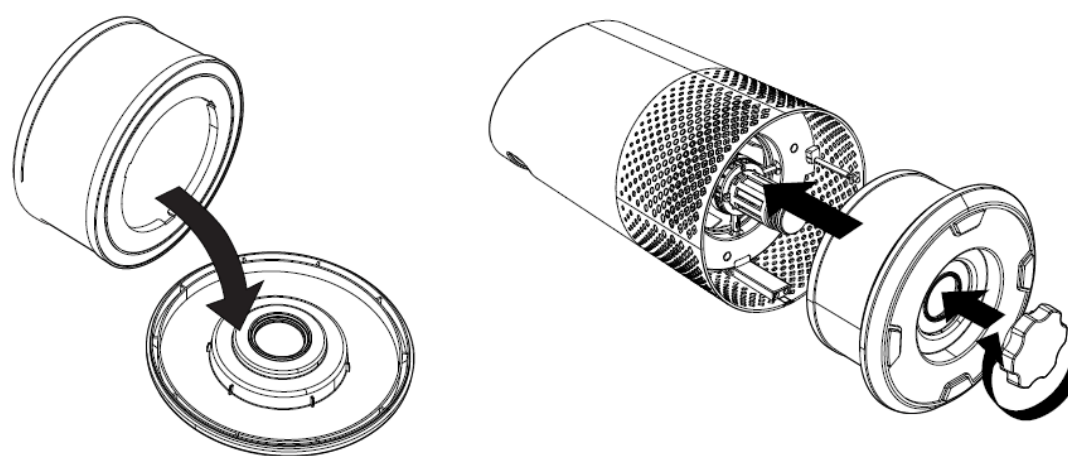

Step 3. Set up

Plug-in your air purifier unit and power on.

Place the purifier on a flat surface, free from obstructions:

- where air can flow freely into the purifier from all sides
- avoiding furnishings like bedding and curtains, as well as sources of heat or moisture.

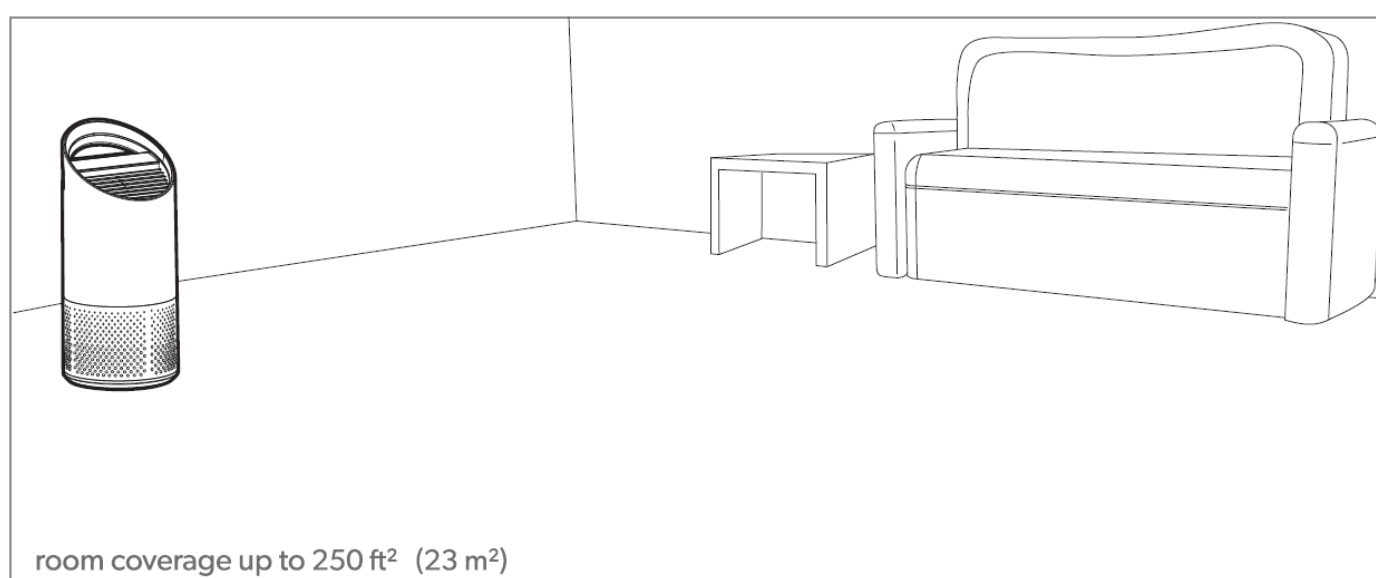

Start living with cleaner air!

Select your preferred fan speed and proprietary PureDirect™ technology will deliver purified air throughout the room!



Get to know your air purifier

- 1. Easy-carry handle
- 2. Simple touch control panel
- 3. 360° air intake
- 4. Filter chamber cover & knob (underneath)



PureDirect™ cleans comfortably and effectively

Independent lab testing of different airflow configurations confirms that dual airflow can distribute air further and more evenly throughout the room.

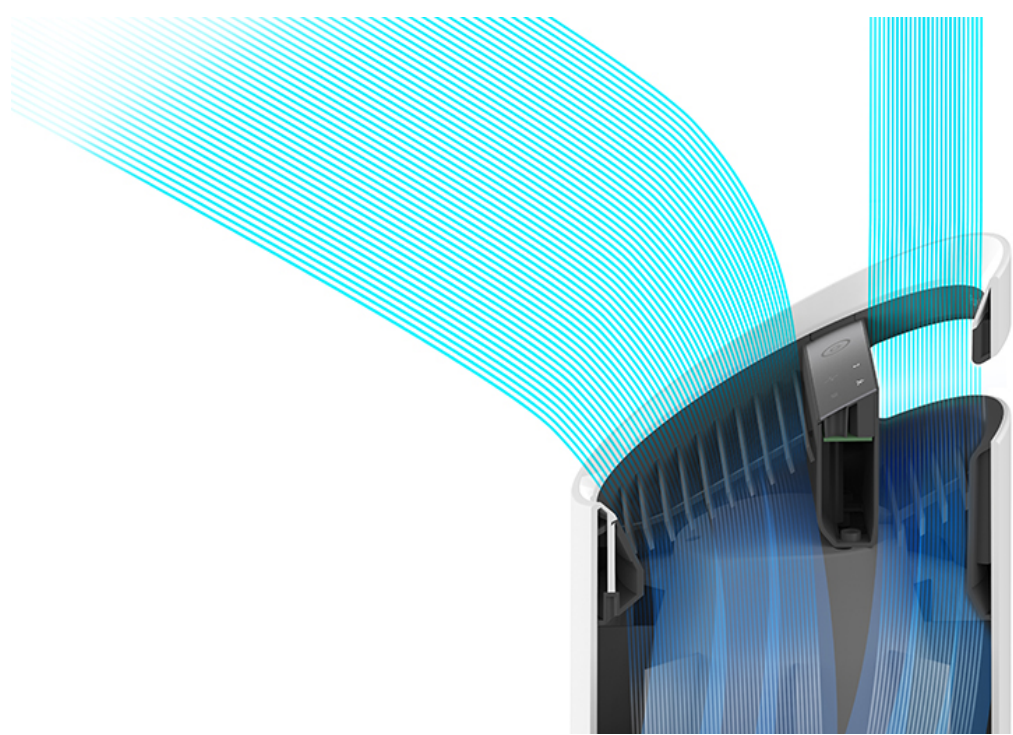

filtration and UV sterilization

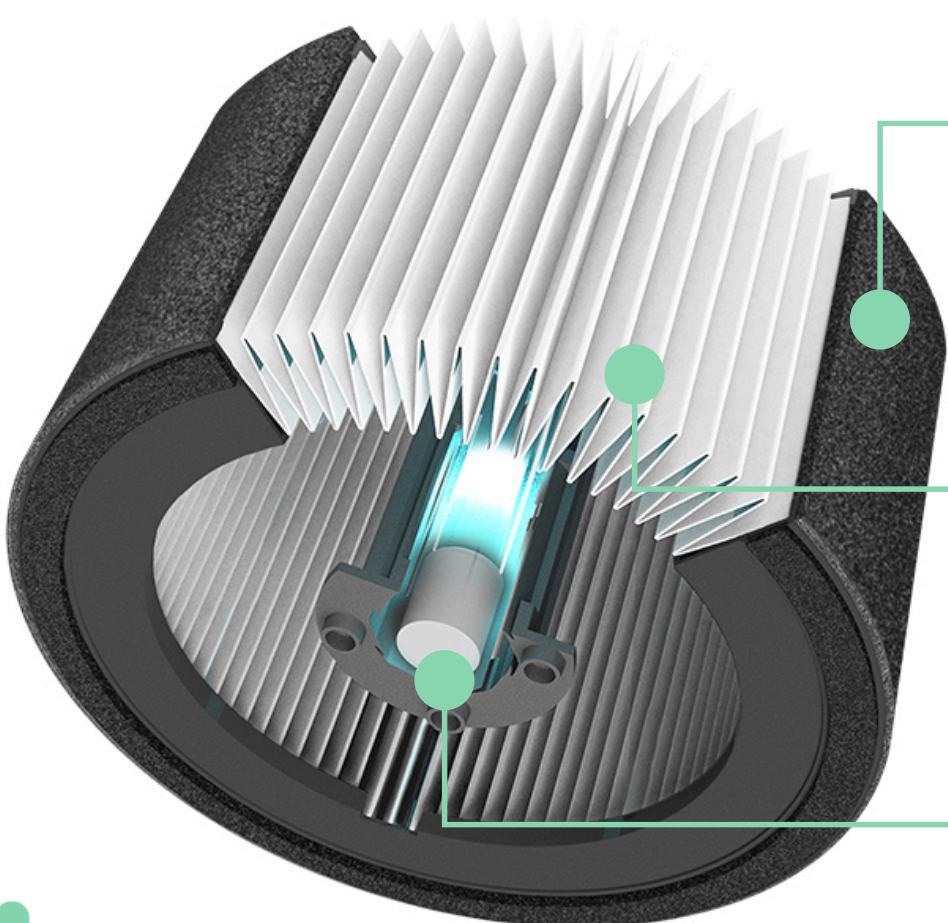

Activated Carbon Prefilter
Captures larger particles like dust and pet hair, and removes certain gases and odors

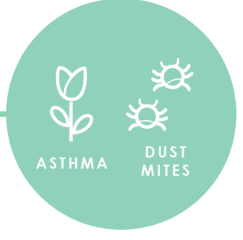

HEPA Filter
Captures particulates down to 0.3 microns

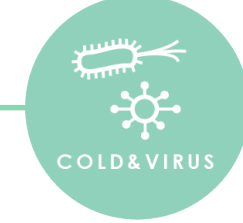



Ultraviolet Sterilization
Reduces the growth of germs and viruses that can build up on the surface of the filter



Control Panel

 Power Button

 Fan Speed Settings
Select fan speed: 1, 2, or Turbo.

UV UV Mode
UV lamp within the purifier’s filter chamber is on when  symbol is white.
 symbol will glow red when it is time to replace the UV lamp. *See pages 8-9 for instructions.*

Reset Filter and UV Indicator Reset
HEPA, Carbon, and UV indicators glow red when it is time for each to be replaced. *See pages 7-9 for instructions.*
When 1 indicator is on, simply hold Reset button for 3 seconds to reset that indicator.
When 2+ indicators are on, press the Reset button to select the correct indicator (selected indicator will blink) before holding 3 seconds to reset that indicator.

Specifications

| | |
|------------------------------|-------------------------------------|
| Air Inlet | 360° |
| Air changed 2 times per hour | 250 ft² (23 m²) |
| Air Delivery Type | PureDirect™ |
| Fan Speed Settings | 1, 2, Turbo |
| Purification Levels | Carbon Prefilter HEPA Type UV |
| Filter Change Indicator Type | Carbon, HEPA, UV |
| Noise | 39 - 65 dB |

| Replacement Filters and UV Lamps | |
|----------------------------------|--------------|
| 360° filter (HEPA, Carbon) | AFH-Z1000-01 |
| Carbon filter (3-pack) | AFC-Z1000-01 |
| Ultraviolet Lamp | UVL-Z1000-01 |

| | |
|--------------------|---|
| Dimensions | 7.7" x 7.7" x 17.9" 195 x 195 x 451 mm |
| Weight | 7.7 lbs (3.5 kg) |
| Motor Type | AC motor |
| Power Requirements | 120v / 60 Hz |
| Power Consumption | 40 W |
| Warranty | 2 years |



Filter Change and Maintenance

Accessing the filter chamber

1. Always power off the purifier by pressing the Power Button and unplugging the power cord.
2. Gently place the unit on its side on the floor so that the filter chamber cover and knob are exposed.
3. Turn the knob counter-clockwise and remove the filter chamber cover and 360° HEPA filter drum (Fig. A).

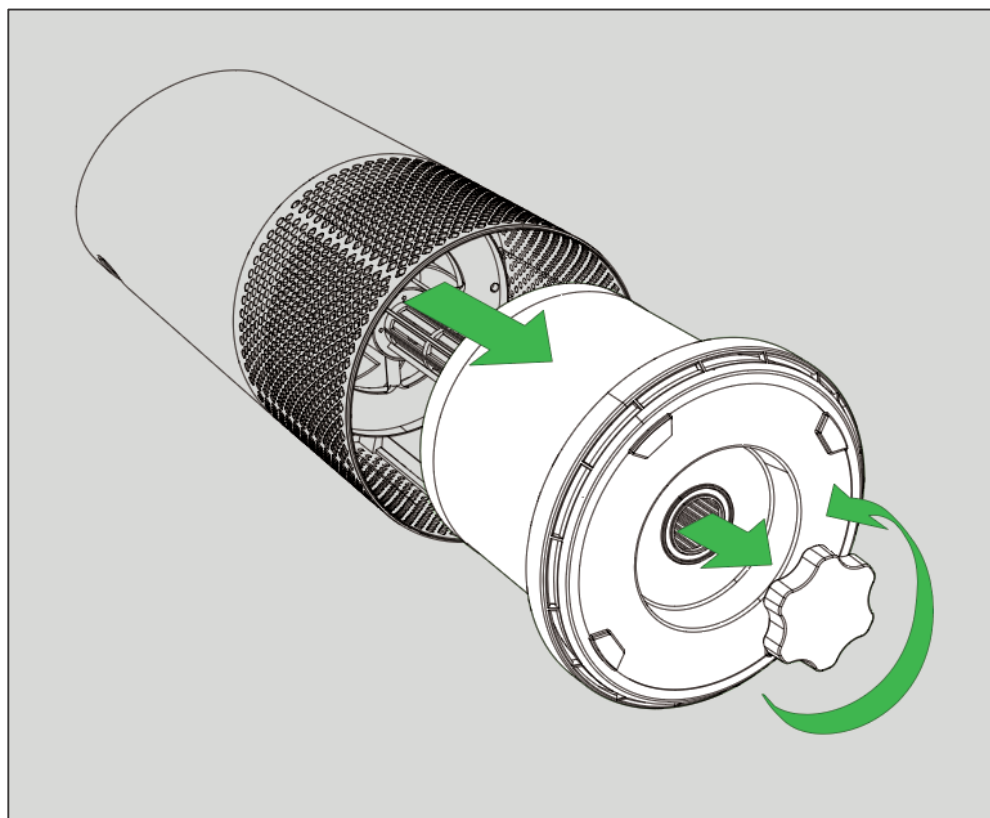

Fig. A

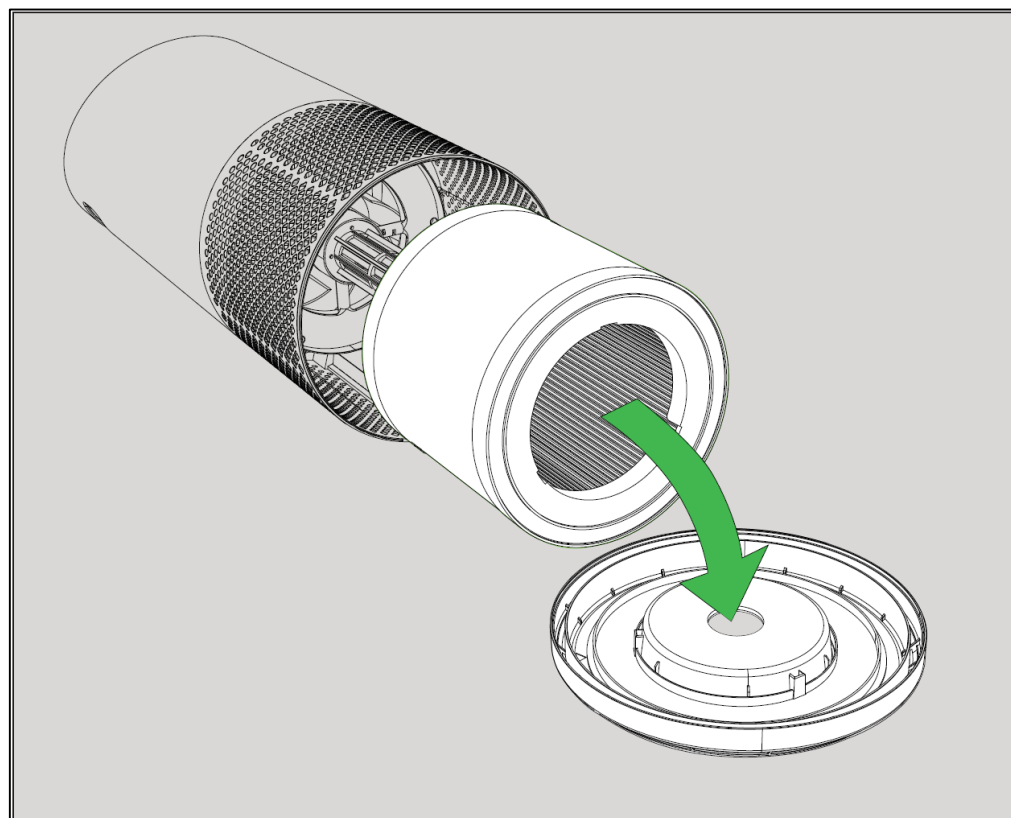

Fig. B

Replacing the 360° **DUPONT™** HEPA drum filter

1. The HEPA indicator will glow red when it is time to change the entire HEPA drum filter.
2. Gently pull the HEPA drum filter away from its place secured to the filter chamber cover (Fig. B).
3. Your replacement HEPA filter (*on page 6*) will include both layers: Carbon Prefilter and HEPA.
4. Secure the replacement HEPA filter onto the filter chamber cover (Fig. C).
5. Gently replace the filter drum and filter cover into the filter chamber and onto the threading, and turn the knob clockwise until the knob and filter chamber cover are securely tightened (Fig. D).
6. After plugging-in and powering-on the purifier, hold the Reset button until the red HEPA indicator turns off.

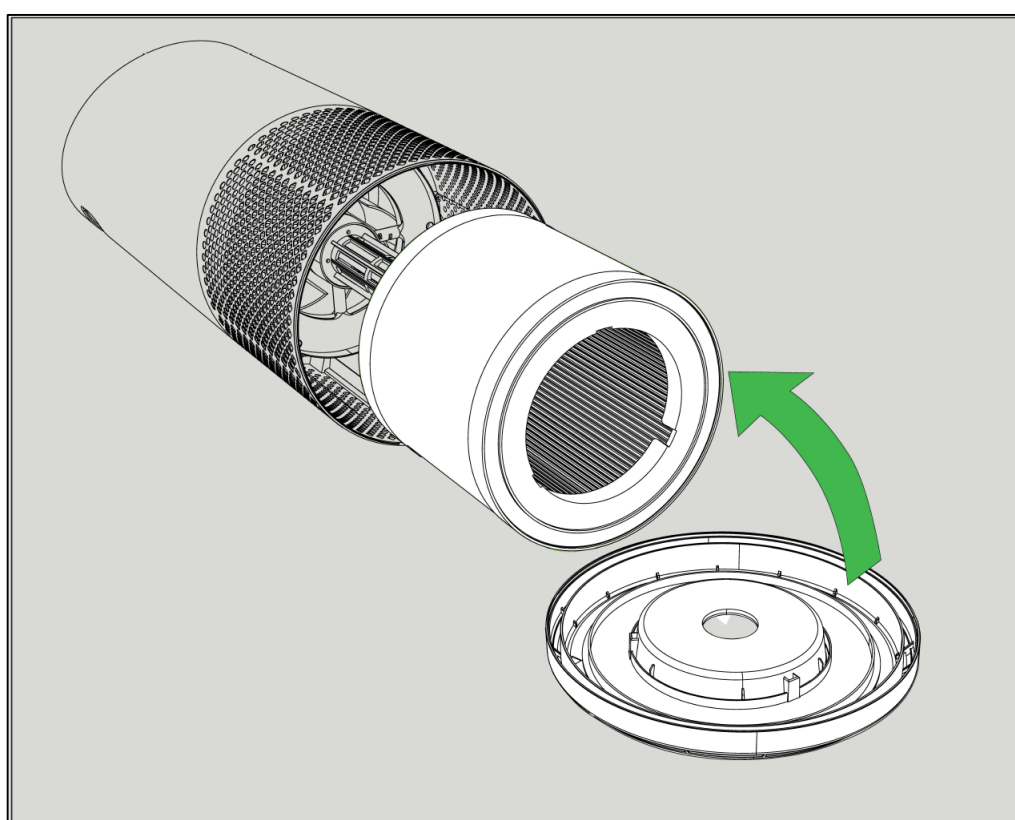

Fig. C

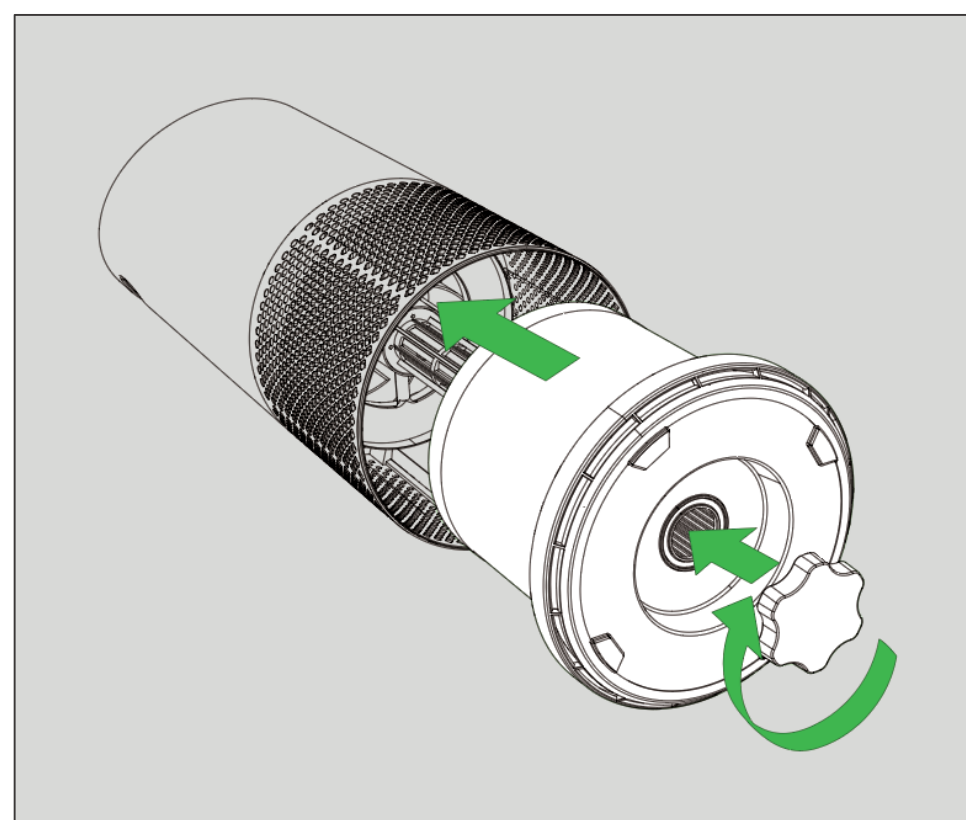

Fig. D

Replacing the Carbon filter

1. The Carbon indicator will glow red when it is time to replace the Carbon Prefilter.
2. Gently peel away the used Carbon Prefilter layer from its fastener strips (Fig. E).
3. Your replacement 3-pack of Carbon filters (*on page 6*) will cover each of the three Carbon changes between changes of the entire HEPA drum filter assembly (*see page 7*).
4. Wrap a new Carbon layer around the filter drum and attach using the same fastener strips (Fig. F).
5. Once the purifier is powered-on, hold the Reset button until the red Carbon indicator turns off.

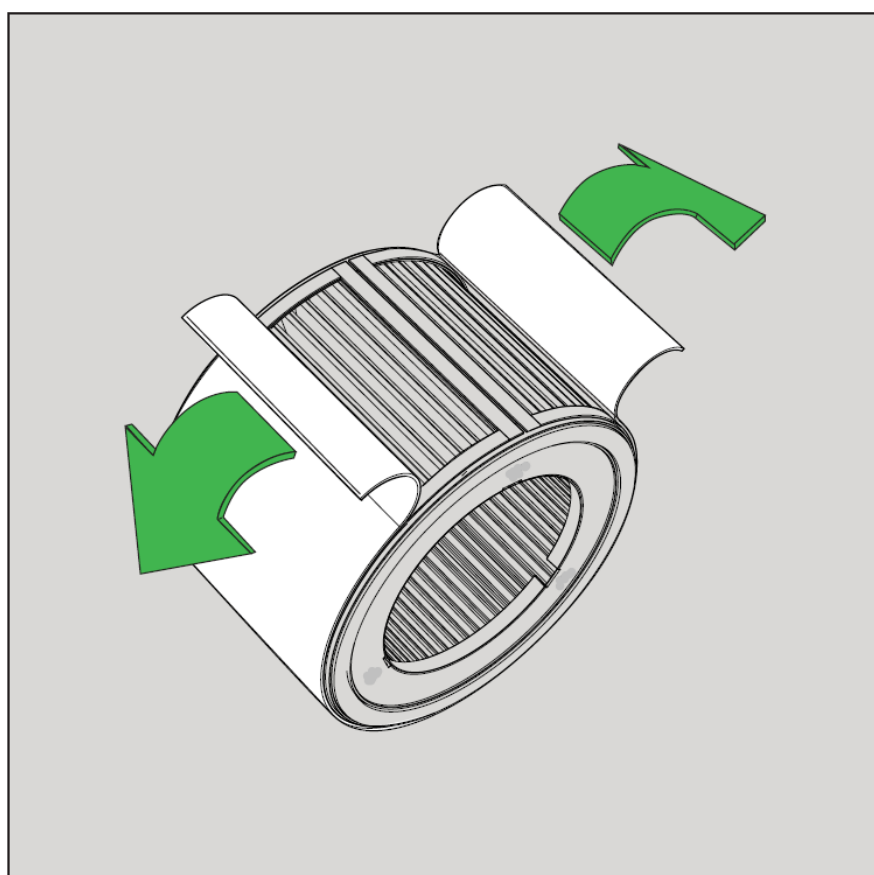

Fig. E

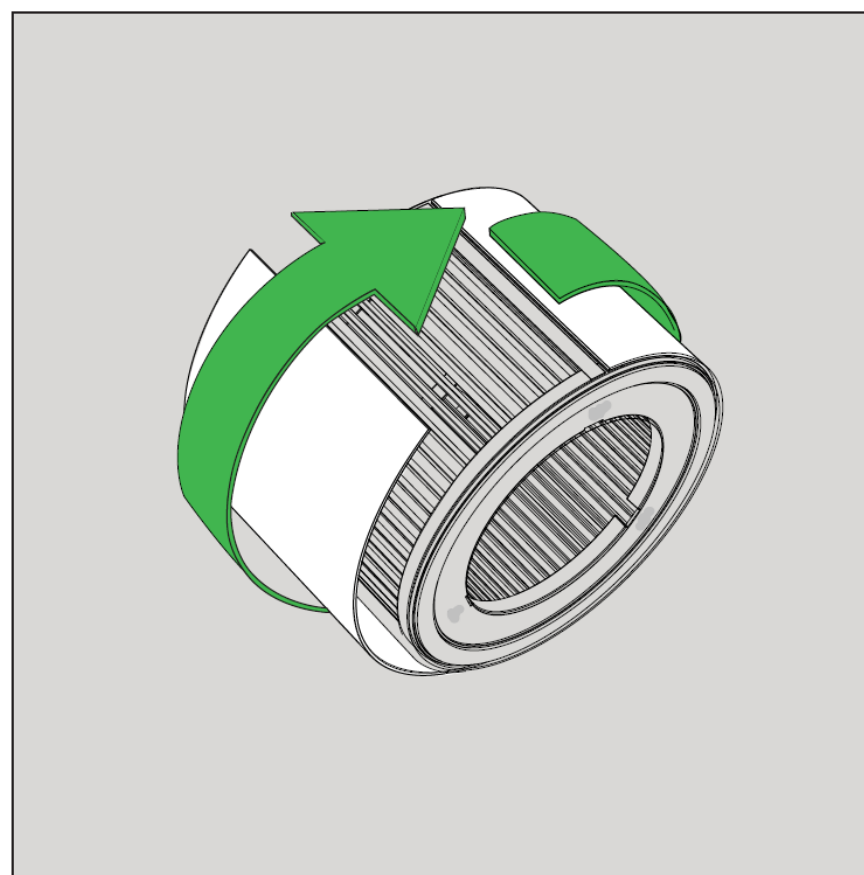

Fig. F

Replacing the UV lamp



1. The  indicator will glow red when it is time to replace the UV lamp.
2. Remove filter drum (Fig. A), and use a screwdriver to remove the screw securing the UV housing (Fig. H).
3. Gently remove UV housing (Fig. I) and release UV lamp from carriage (Fig. J).
4. Disconnect UV lamp clip from socket (Fig. K) and replace by connecting new UV lamp (*on page 6*).
5. Secure UV lamp into carriage (Fig. L) and re-install carriage into purifier (Fig. M).
6. Replace the UV housing (Fig. N) and use a screwdriver to tighten the fastening screw (Fig. O).
7. Once the purifier is powered-on, hold the Reset button until the  indicator turns white.



Fig. H

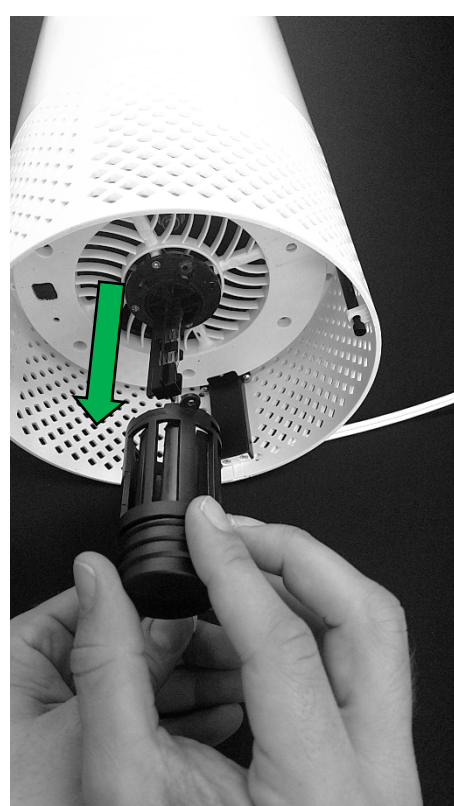

Fig. I

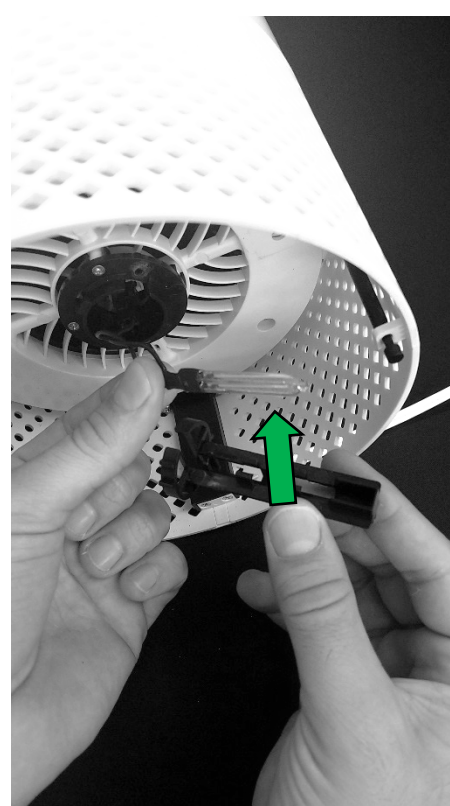

Fig. J

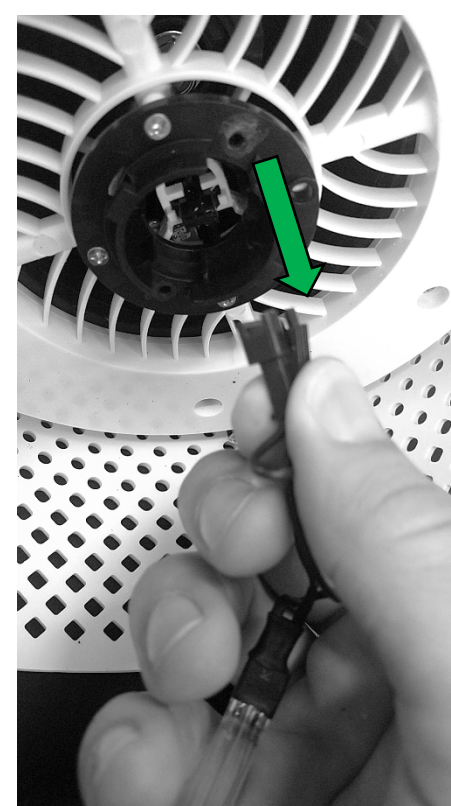

Fig. K

Replacing the UV lamp (continued)

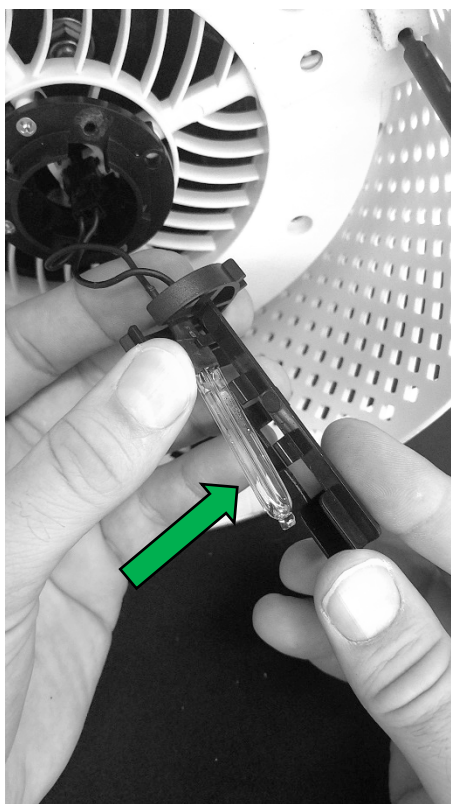

Fig. L



Fig. M

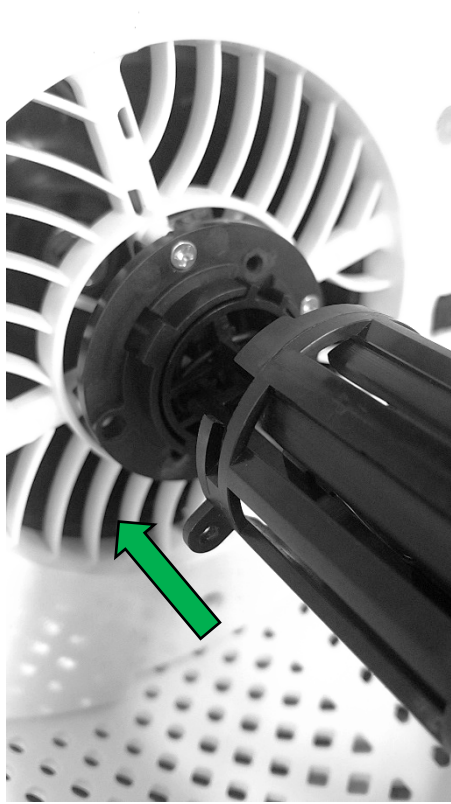

Fig. N



Fig. O

Troubleshooting and FAQ

| | |
|--|--|
| How often do I need to change the filters? | That's easy! The purifier's replacement indicators will notify you when it is time to replace the Carbon or HEPA filters, or the UV lamp. Plan on replacing the Carbon every 3-4 months, HEPA every 12-15 months, and UV lamp every 1-3 years. |
| Purifier won't turn on. | Check that the power cord is connected securely to both the wall outlet and the purifier. Check if there is a power outage in the outlet by trying a nearby light or device or by trying a working device in the same outlet. Check that the HEPA filter is fitted properly into filter chamber. Please contact us if you're still having a problem! (page 10) |

Support

Thank you for welcoming TruSens™ into your home. Our customers are at the heart of what we do, and we strive to design products that fit your lifestyle. If you have any questions or feedback, please reach out!



Visit our website at www.trusens.com



Email us at support@trusens.com



Call us at **1-833-TRUSENS**
(1-833-878-7367)

And visit us and share your experience with us on social media!



/TruSensWellness



@Tru_Sens



@tru_sens



TruSens

Warranty

TruSens warrants that the machine will be perform to the specifications stated and be free from defects in materials and workmanship for a period of 2 years from date of purchase, subject to normal use. Within the guarantee period, TruSens will at its own discretion either repair or replace the defective machine free of charge. Defects due to shipping, misuse, improper maintenance or the use of any parts from another manufacturer are not covered under this guarantee. Proof of date of purchase will be required. Repairs or alternations made by persons not authorized by TruSens will invalidate the guarantee. This guarantee does not affect the legal rights which consumers have under applicable national legislation governing the sale of goods.



Experience the difference

www.trusens.com